

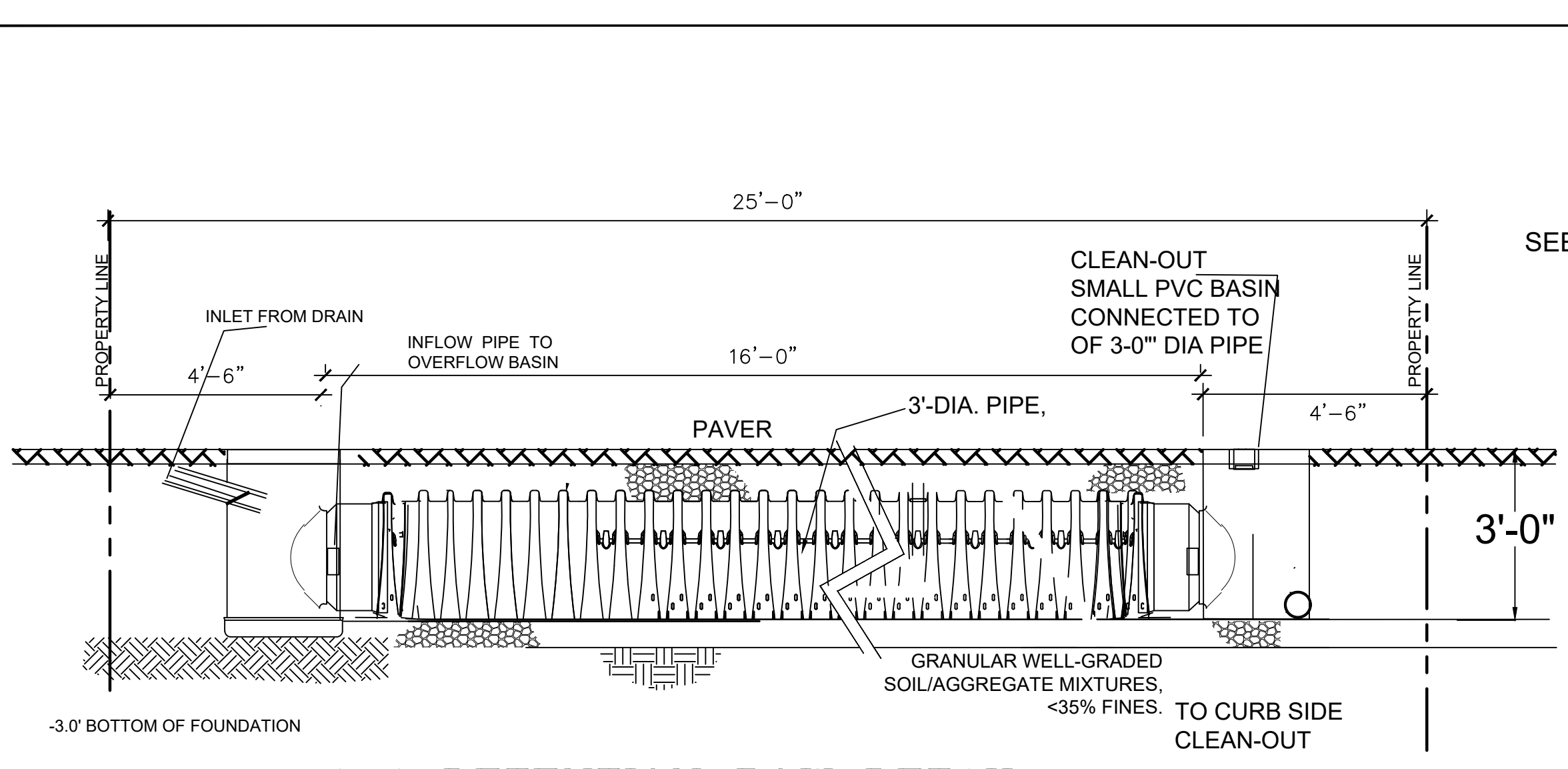

OPTIMIZED ENGINEERING ASSOCIATES  
 400 38TH STREET, SUITE 307  
 UNION CITY, NJ 07087  
 201-430-9173  
 201-866-0913 (FAX)  
 E-mail: guy@oea-corp.com  
 Web: www.oea-corp.com

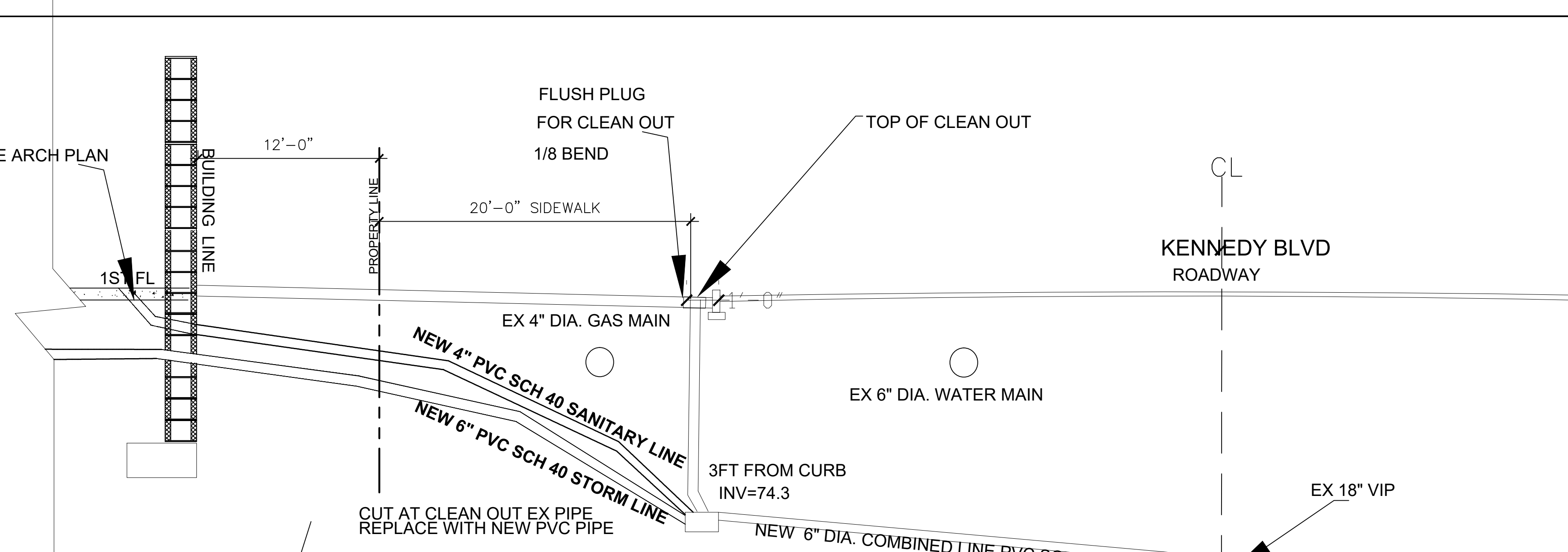

**1-1 DETENTION ROW DETAIL**  
 NOT TO SCALE



**3-3 CROSS SECTION**  
 NOT TO SCALE

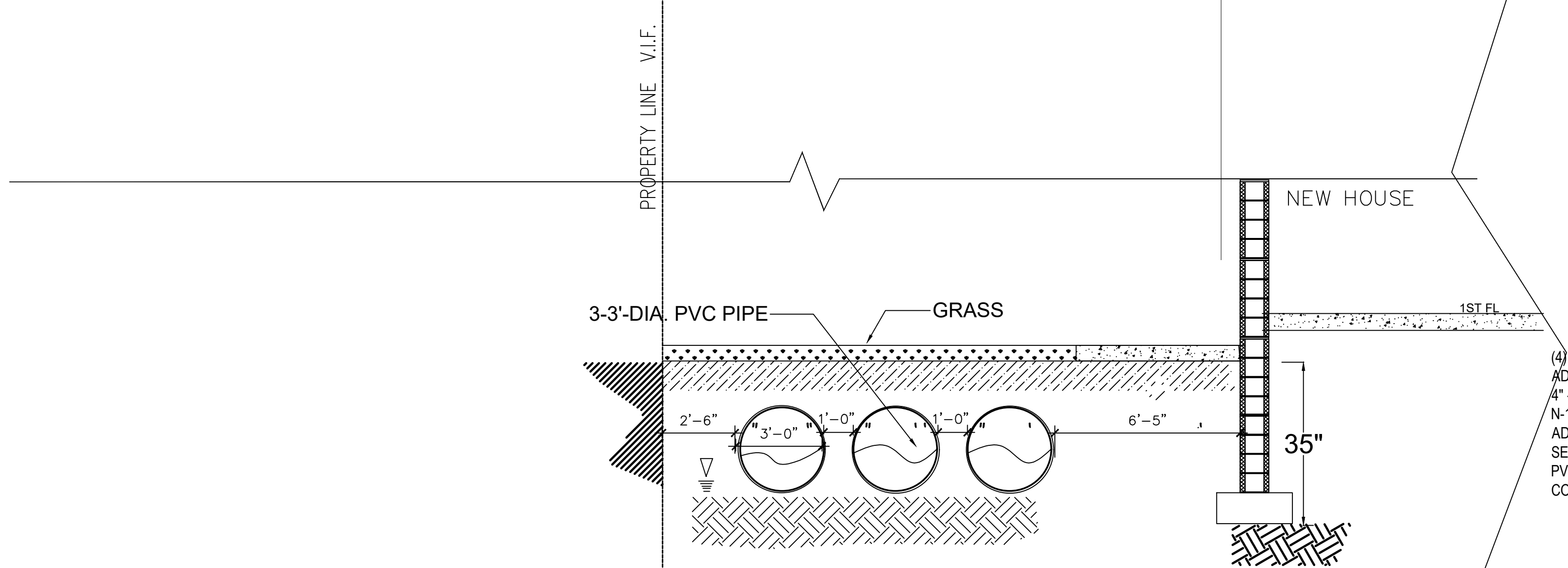

**2-2 CROSS SECTION DETAIL**  
 NOT TO SCALE

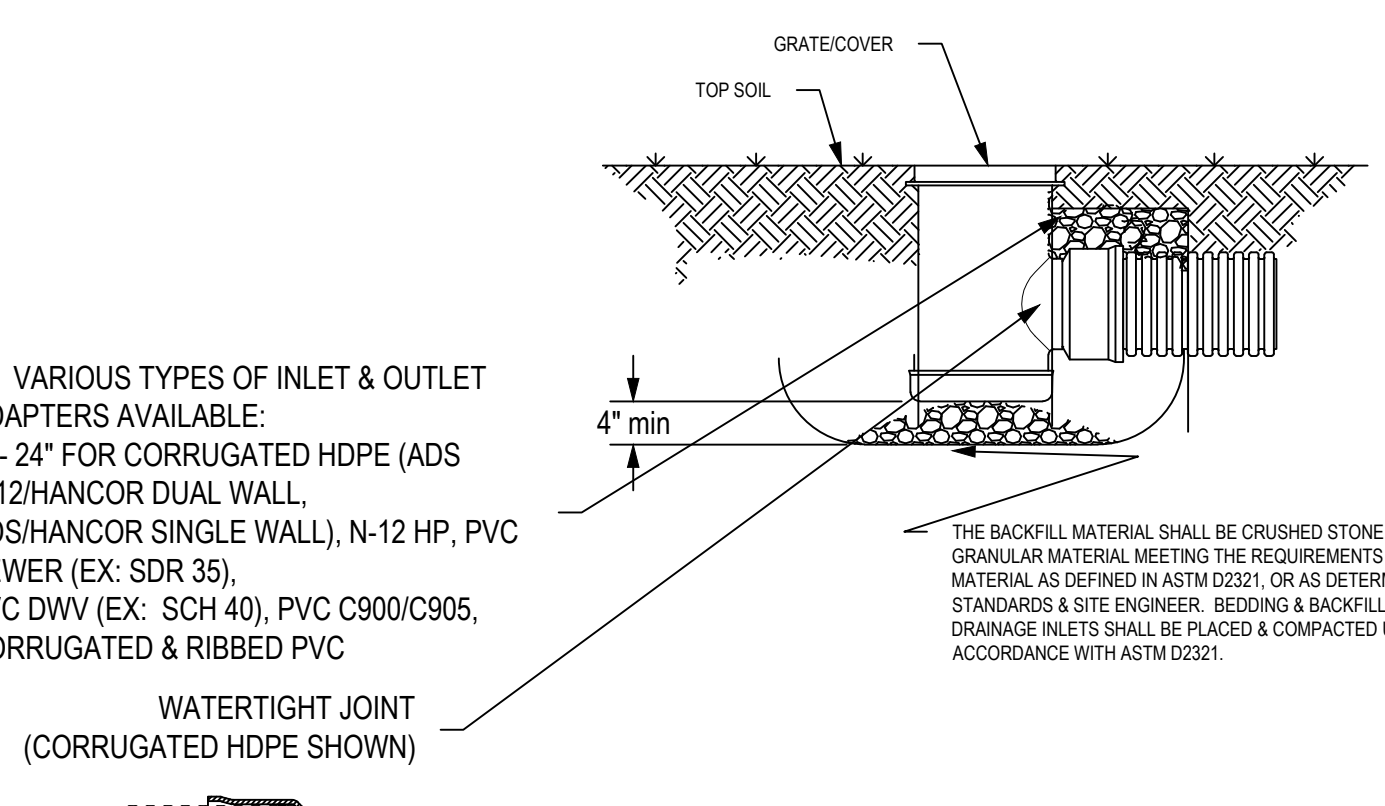

**1 COLLECTOR DRAIN BASIN**  
 C-103

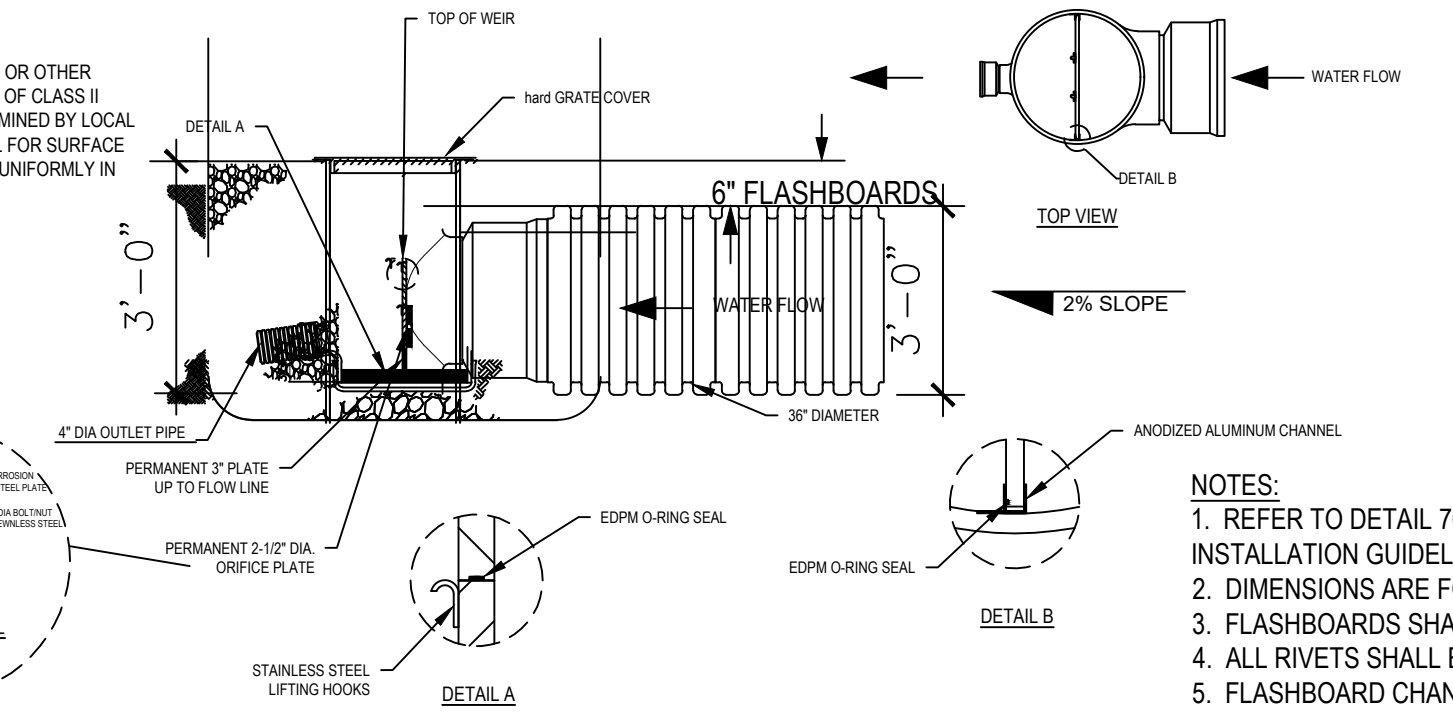

**2 36" NYLOPLAST WATER CONTROL STRUCTURE**  
 C-103

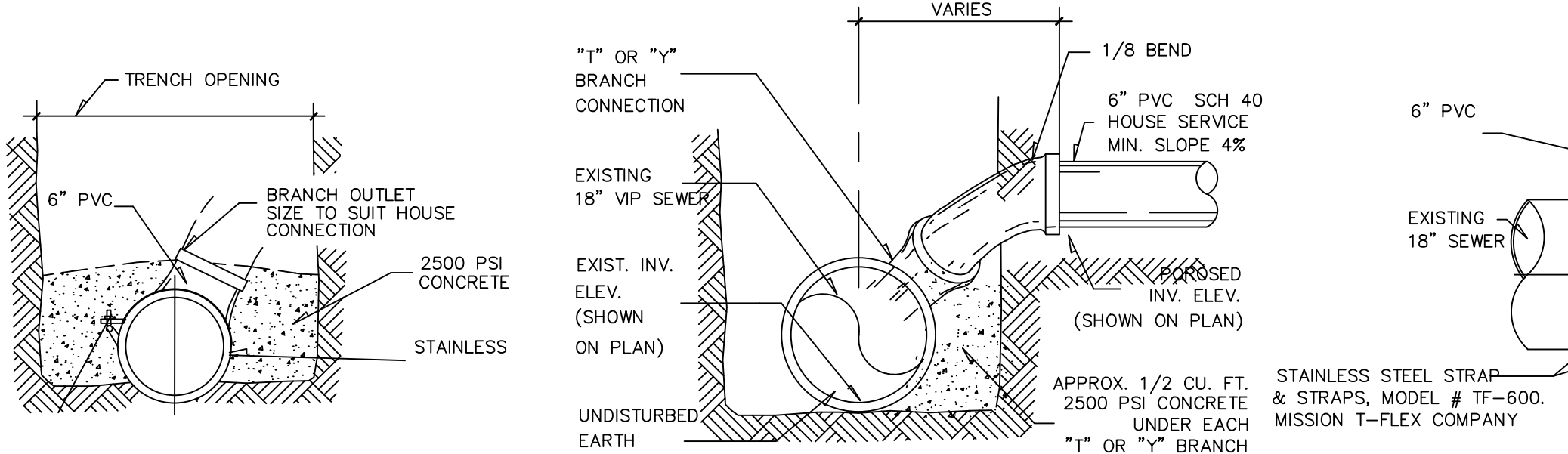

**BUILDING LATERAL CONNECTION DET.**  
 N.T.S.

**FIELD CUT-IN BRANCH CONNECTION**  
 N.T.S.

**SANITARY OR STORM CONNECTION DETAIL**

- BACKFILL PLACEMENT**
- 1) Provide all fill material required to achieve grades as shown on drawings.
  - 2) Subbase shall be firm and approved by the engineer or his representative prior to placement.
  - 3) Place and compact backfill in lifts not to exceed 3 feet where heavy compaction is used. Otherwise 6" lifts.
  - 4) Compact backfill to 95% of the maximum density as by ASTM D1557. Maintain moisture content of the backfill material prior to and during compaction uniformly distributed throughout each layer and within 2% percent of optimum water content.
  - 5) Contractor shall verify all demensions in field.

NOTE: THE PLUMBER NEEDS TO EITHER CUT OR DRILL OUT THE HOLE FOR THE SERVICE CONNECTION WITH A HOLE SAW AND THAT BREAKING A HOLE WITH A HAMMER IS PROHIBITED.

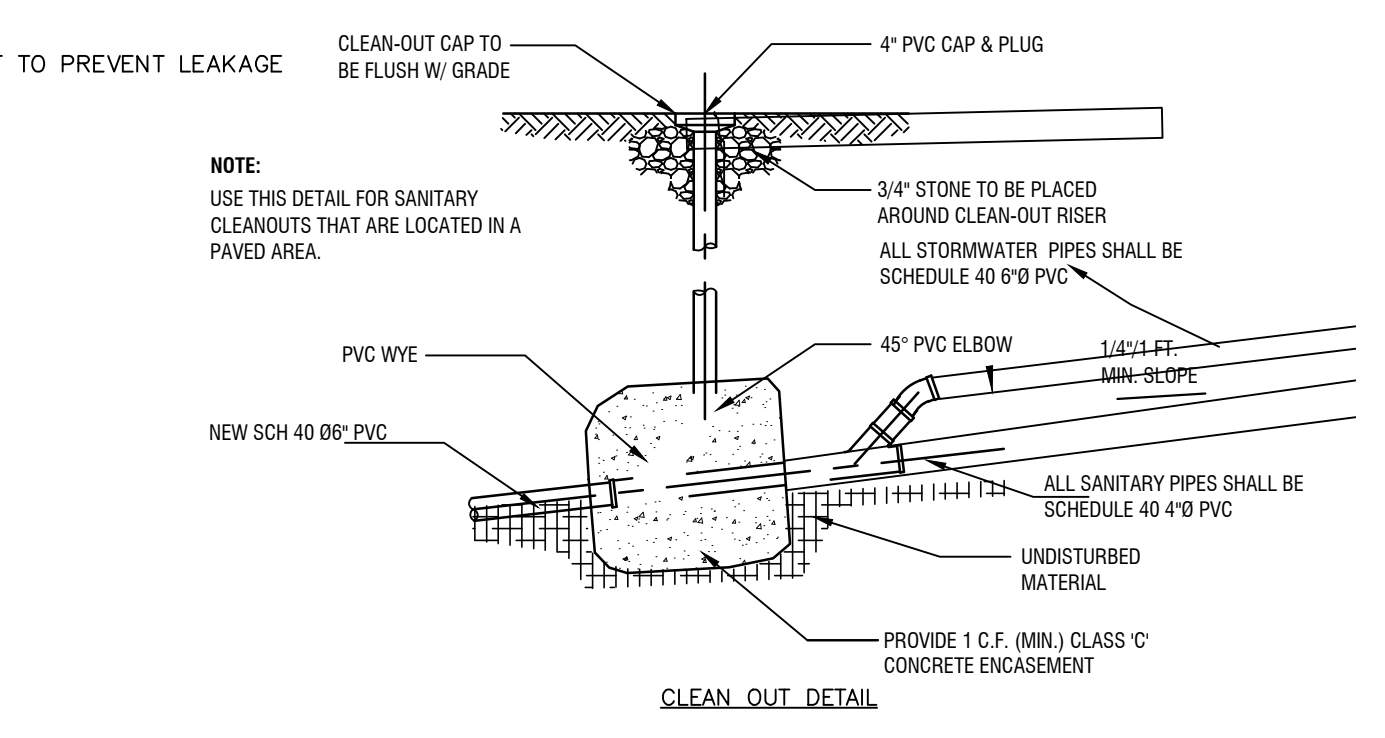

**4 SANITARY/STORM CLEAN-OUT IN PAVEMENT**  
 C-103

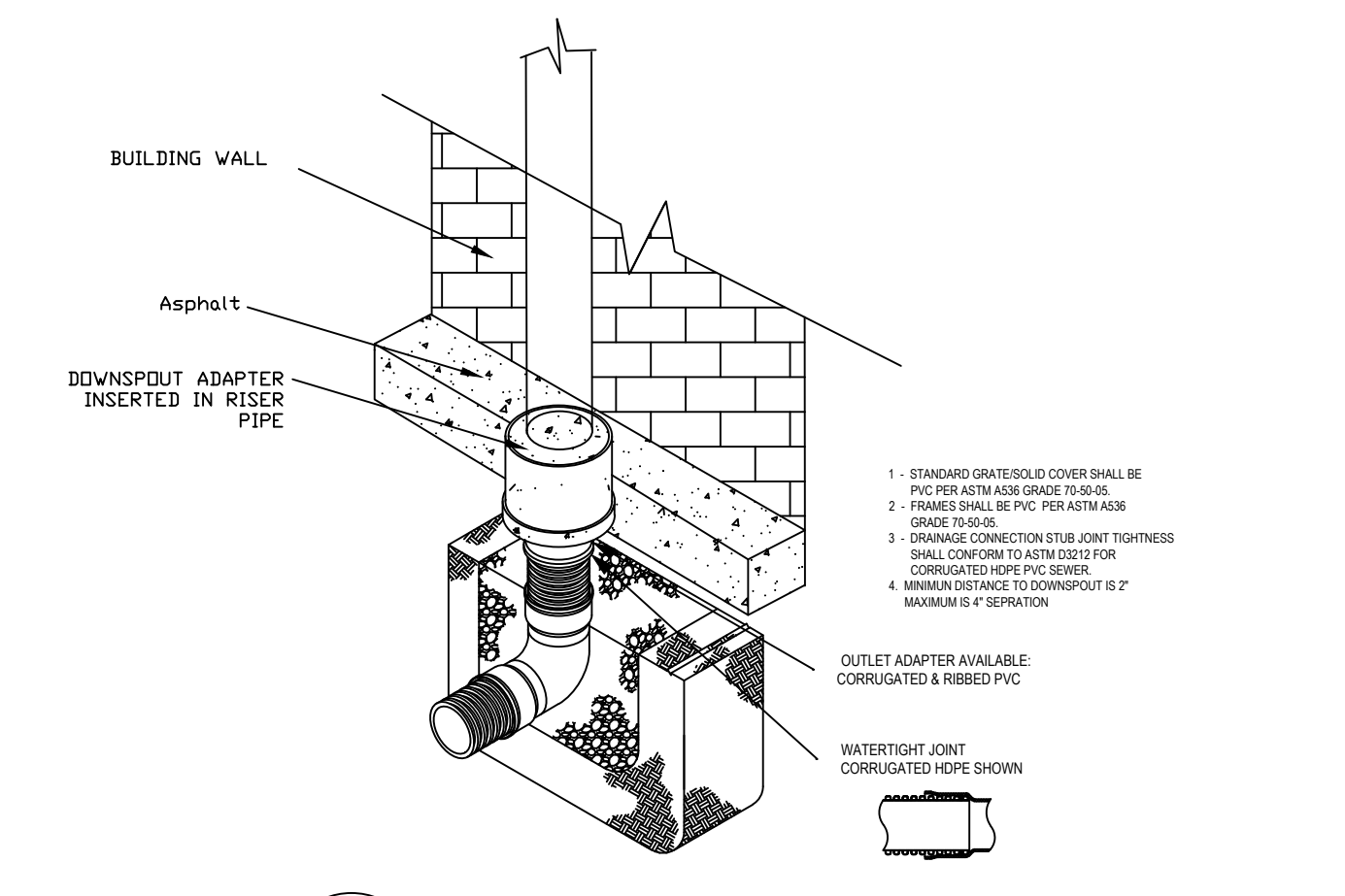

**3 ROOF DRAIN W/CLEANOUT**  
 C-103

REVISIONS:	NO.	DATE	DESCRIPTION	APPROD

**PROJECT LOCATION:**  
 3447 KENNEDY BOULEVARD  
 JERSEY CITY, NJ  
 BLOCK: 2602 LOT: 19

**PROJECT DESCRIPTION:**  
 DRAINAGE DETAILS FOR  
 NEW 3-STORY RESIDENTIAL

SEAL: *[Signature]*

DR: GJ TR: CK  
 CK DES: CK  
 GUY LAGOMARSINO, P.E.  
 PROFESSIONAL ENGINEER  
 LICENSE NO. (N.J.): 246240034

SCALE: NTS

DATE: MARCH 2022

C-103  
 SHEET 3 OF 3