



# JERSEY CITY MUNICIPAL UTILITIES AUTHORITY

13-15 LINDEN AVENUE EAST 1<sup>ST</sup> FLOOR-JERSEY CITY, NEW JERSEY 07305 • TEL: (201) 432-1150 • FAX: (201) 432-1576

JOSE R. CUNHA, P.E.  
EXECUTIVE DIRECTOR

JOHN D. FOLK, C.P.A.  
DIRECTOR OF FINANCE

## BOARD OF COMMISSIONERS MAUREEN HULINGS, CHAIRPERSON

JEANNINE ZAMPELLA  
VICE-CHAIRPERSON

MAUREEN NALLY  
SECRETARY

MOFALC O. MEINGA  
COMMISSIONER

KATHLEEN HARTYE  
COMMISSIONER

DAVID MOORE  
COMMISSIONER

June 7, 2022

Tanya R. Marione, AICP, PP  
Principal Planner  
Division of City Planning  
30 Montgomery Street, Suite 1400  
Jersey City, NJ 07302

RE: Ocean Avenue Ward A Study Area

Dear Ms. Marione:

This letter is to certify that the majority of water and sewer infrastructure serving the above referenced area, on Ocean Avenue between New Street and Eastern Parkway, is at least 50 years old. As is typical for infrastructure of this age, the Jersey City Municipal Utilities Authority (JCMUA) performs ongoing maintenance and repairs to keep the infrastructure assets from failing. Replacement or rehabilitation of these assets would prevent their further deterioration and promote the overall development of this community.

Please contact me at 201-432-1150 if you have any questions regarding this matter.

Very truly yours,

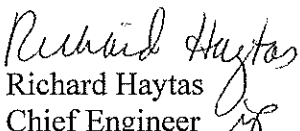
  
Richard Haytas  
Chief Engineer  
Jersey City Municipal Utilities Authority

Cc: Jose Cunha, P.E. Executive Director  
Joseph Coviello, Deputy Director

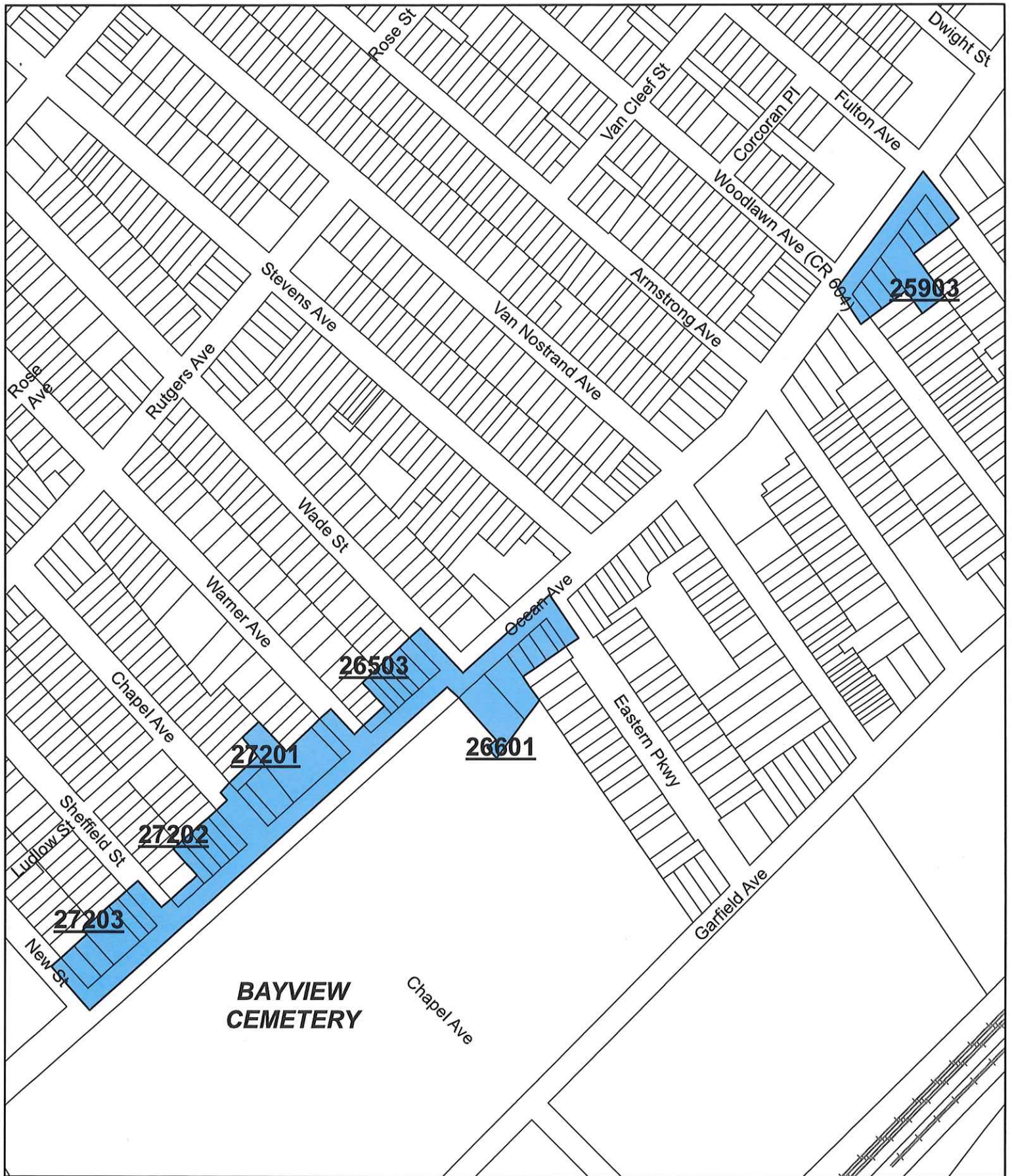

**OCEAN AVENUE WARD A STUDY AREA  
BOUNDARY MAP**

DECEMBER 21, 2021



**Legend**

-  Study Area Boundary
-  Parcels

