



CITY OF JERSEY CITY

Office of the City Assessor
280 Grove Street, Room 116
Jersey City, New Jersey 07302
Telephone: (201) 547-5131

EDUARDO TOLOZA, CITY ASSESSOR

August 2, 2021

PROPERTY LOCATION OF APPLICATION: 700 Washington Boulevard

BLOCK(S): 7302 LOT(S): 3.04

NAME OF APPLICANT: Ronald H. Shaljian, Esq.
Schumann Hanlon, LLC
30 Montgomery Street, Suite 990
Jersey City, NJ 07302

APPLICANT'S TELEPHONE #: (201) 451-1400

Pursuant to your request, attached herewith is a list of properties located within the 200-foot radius of the above-captioned property. This list contains the owner's name, mailing address, block, lot and property location as reflected on the most recent Assessor's Tax List.

C E R T I F I E D



EDUARDO TOLOZA, City Assessor

Also be advised that the following companies must be notified:

P.S.E.& G.	80 PARK PLAZA, NEWARK, NEW JERSEY 07102
COMCAST CABLEVISION	2121 KENNEDY BLVD., JERSEY CITY, NJ 07305
UNITED WATER COMPANY	200 HOOK ROAD, HARRINGTON PARK, NJ 07640
JERSEY CITY M.U.A.	555 ROUTE 440, JERSEY CITY, NEW JERSEY 07305
VERIZON TELEPHONE	540 BROAD STREET, NEWARK, NEW JERSEY 07102

Jersey City

Created on Mon Aug 02 2021

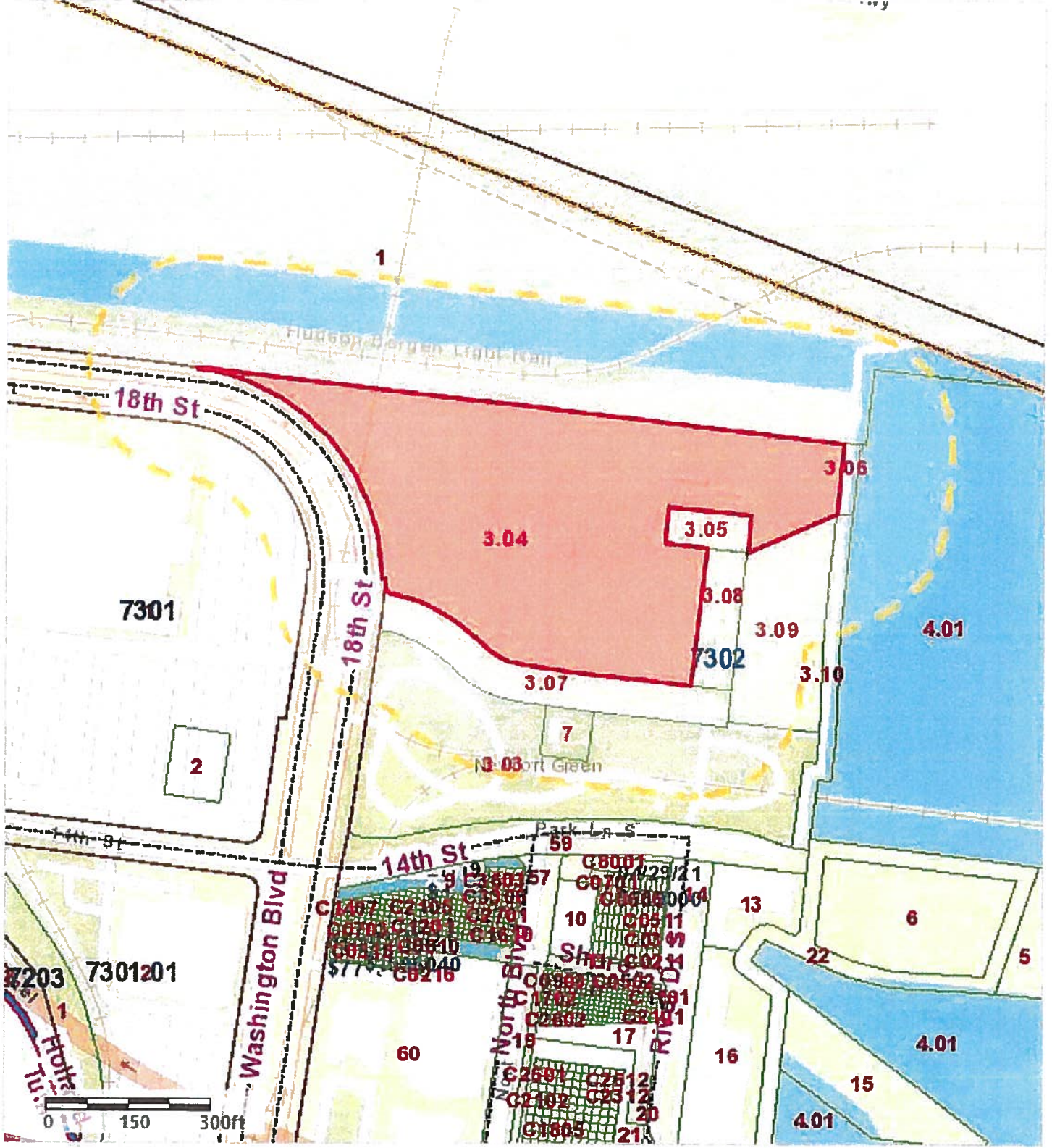

notes:

200 Ft. Buffer Report Map
Block 7302 - Lot 3.04



CITY OF JERSEY CITY

Office of the City Assessor

Subject Property: Block 7302 - Lot 3.04

Block & Lot listing of properties within 200 ft. radius of subject property.

Property Location: 700 Washington Boulevard

Date: August 2, 2021

BLOCK	LOT	QUAL	PROPERTY LOCATION	OWNERS NAME	MAILING ADDRESS	CITY / STATE	ZIP CODE
7301	1		100 FOURTEENTH ST.	NEWPORT/18TH ST. LTD.	P.O. BOX 9456 (TARGET)	MINNEAPOLIS, MN.	55440
7302	1		686 MARIN BLVD.	STATE OF NJ DEPT. OF TRANSPORTATION	1035 PARKWAY AVE	TRENTON, N J	08625
7302	3.03		636 WASHINGTON BLVD.	NEWPORT CENTRE	40 W. 57TH ST.,#23 FL.	NEW YORK, NY	10019
7302	3.05		RIVER DRIVE	NEWPORT CENTRE	40 WEST 57TH ST 23RD FL	NEW YORK, NY	10019
7302	3.06		HUDSON RIVE WW	NEWPORT CENTRE	40 WEST 57TH ST 23RD FL	NEW YORK, NY	10019
7302	3.07		SIXTEENTH ST.	NEWPORT CENTRE	40 WEST 57TH ST 23RD FL	NEW YORK, NY	10019
7302	3.08		RIVER DR	NEWPORT CENTRE	40 WEST 57TH ST 23RD FL	NEW YORK, NY	10019
7302	3.09		180 RIVER DRIVE	WAVE PROPERTY LLC	111 TOWN SQUARE PLACE	JERSEY CITY, NJ	07310
7302	3.10		HUDSON RIVER WW	NEWPORT CENTRE	40 WEST 57TH ST 23RD FL	NEW YORK, NY	10019
7302	4.01		2 FOURTEENTH ST.	NEWPORT CENTRE	40 W. 57TH ST.,#23FL.	NEW YORK, NY	10019
7302	7		66 PARK LANE SOUTH(REAR)	NEWPORT CENTRE	97-77 QUEENS BLVD.	REGO PARK, N.Y.	11374

Ronald H. Shaljian

From: Lucien Taturan <LTaturan@jcnj.org>
Sent: Monday, August 2, 2021 10:52 AM
To: Ronald H. Shaljian
Cc: Edward Toloza
Subject: Block 7302 - Lot 3.13

Ron,

In connection with your request for a certified list of property owners within 200 Ft. Radius of subject property, said lot is still not in our current tax map as well as assessment record since our office is still waiting for the final designations of the road surrounding the subdivided lot 3.04 of block 7302. Hence to facilitate with your request, lot 3.04 will be used to generate said list (as agreed over the phone).



Butch Taturan
Technical Assistant - Land Use
[Office of the City Assessor](#)
364 M.L. King Drive, 3rd Floor
Jersey City, NJ 07305
201.547.5167

SCHUMANN HANLON
MARGULIES LLC ATTORNEYS AT LAW
founded in 1850 as Scudder & Gilchrist and
1923 as Brigadier & Margulies

RONALD H. SHALJIAN
rshaljian@shdlaw.com
*Member New Jersey and New York Bar

30 MONTGOMERY STREET, STE 990
JERSEY CITY, NJ 07302
(201) 451-1400 (PHONE)
(201) 432-3103 (FAX)

July 26, 2021

City Tax Collector
280 Grove Street
City Hall, Room 101
Jersey City, NJ 07302

Re: 30 Park Lane North
Block 7302, Lot 3.13

Dear To Whom it May Concern:

Enclosed please find the request for verification of tax payments for the above property.

Also please find a check for your fee in the amount of \$5 made payable to the Jersey City Tax Collector.

Thank you.

Very truly yours,

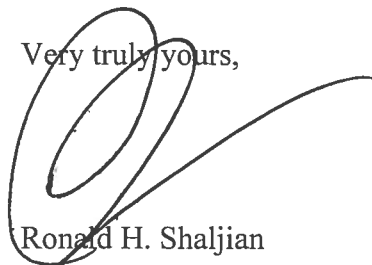
A handwritten signature in black ink, consisting of a large, stylized 'R' followed by a long horizontal stroke that curves upwards at the end.

Ronald H. Shaljian

RHS:pd
Enc.