

- 1 - 30" STANDARD GRATES SHALL BE DUCTILE IRON PER ASTM A536 GRADE 70-50-5.
- 2 - 30" FRAMES SHALL BE DUCTILE IRON PER ASTM A536 GRADE 70-50-5. 8" & 10" STANDARD GRATES FIT DIRECTLY ONTO DRAIN BASINS WITH THE USE OF A PVC BODY TOP.
- 3 - DRAIN BASIN TO BE CUSTOM MANUFACTURED ACCORDING TO PLAN DETAILS. RISERS ARE NEEDED FOR BASINS OVER 84" DUE TO SHIPPING RESTRICTIONS.
- 4 - DRAINAGE CONNECTION STUB JOINT TIGHTNESS SHALL CONFORM TO ASTM D3212 FOR CORRUGATED HDPE (ADS N-12 HANCOR DUAL WALL).
- 5 - ADAPTERS CAN BE MOUNTED ON ANY ANGLE 0° TO 360°. TO DETERMINE MINIMUM ANGLE BETWEEN ADAPTERS SEE DRAWING NO. 7001-110-012.
- 6 - 12" & 10" STANDARD GRATES SHALL MEET F-101 DRAIN RATING.
- 7 - 8" & 10" STANDARD GRATES ARE RATED FOR LIGHT DUTY APPLICATIONS ONLY. NO CONCRETE COLLAR NEEDED FOR LIGHT DUTY RATING.

1 INLET COLLECTOR DRAIN BASIN

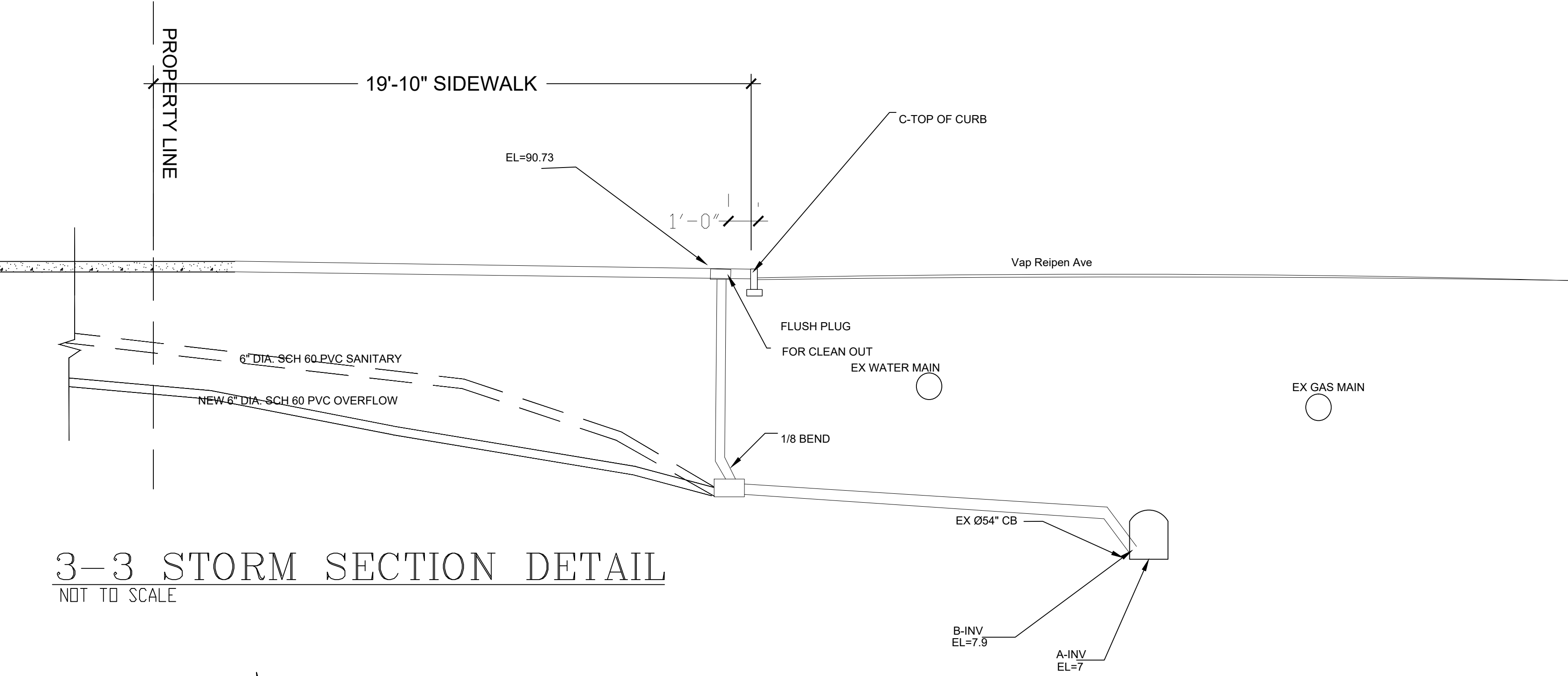

3-3 STORM SECTION DETAIL NOT TO SCALE

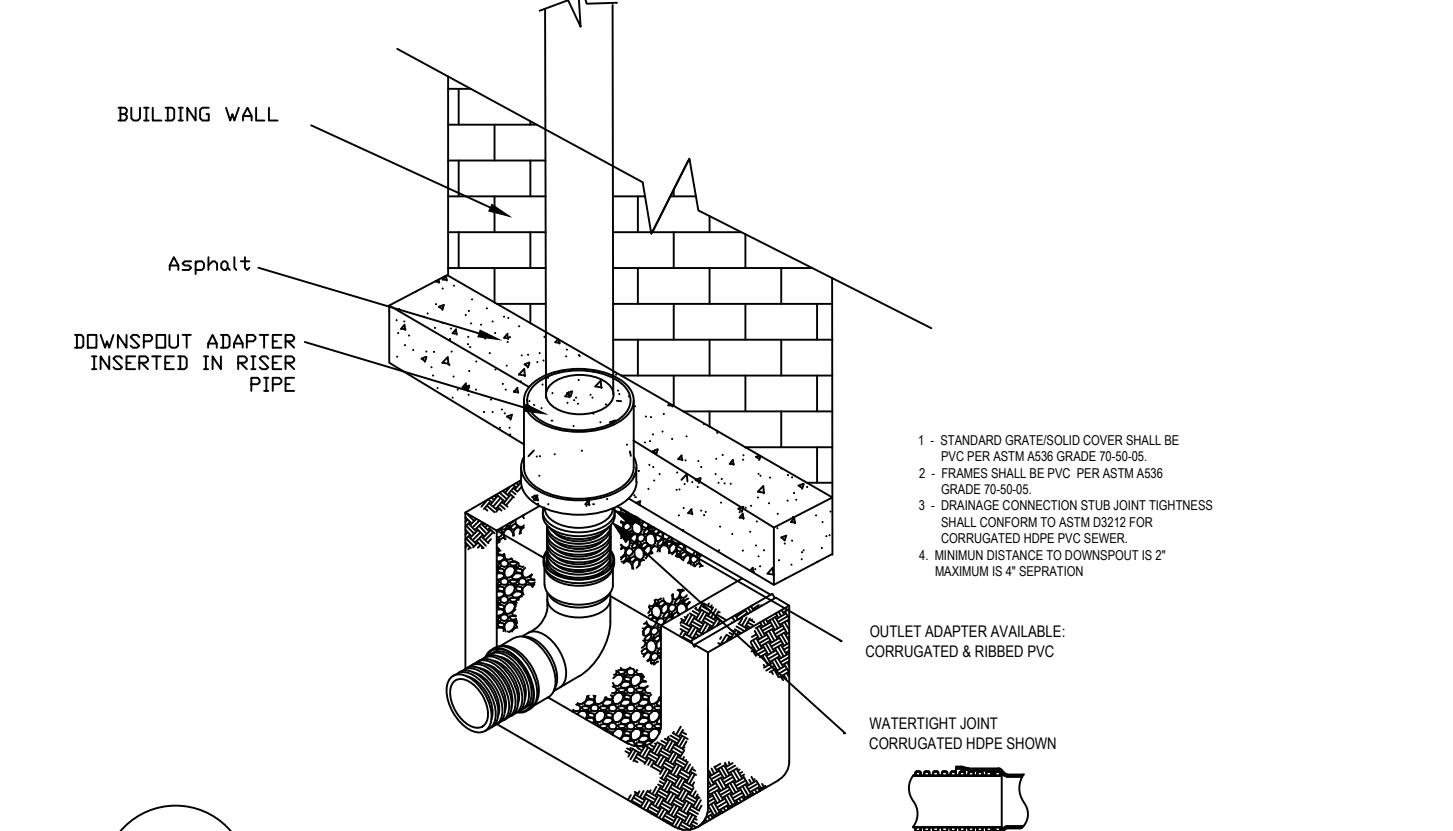

3 ROOF DRAIN W/CLEANOUT

BACKFILL PLACEMENT

- 1) Provide all fill material required to achieve grades as shown on drawings.
- 2) Subbase shall be firm and approved by the engineer or his representative prior to placement.
- 3) Place and compact backfill in lifts not to exceed 3 feet where heavy compaction is used. Otherwise 6" lifts.
- 4) Compact backfill to 95% of the maximum density as by ASTM D1557. Maintain moisture content of the backfill material prior to and during compaction uniformly distributed throughout each layer and within 2% percent of optimum water content.
- 5) Contractor shall verify all demensions in field.

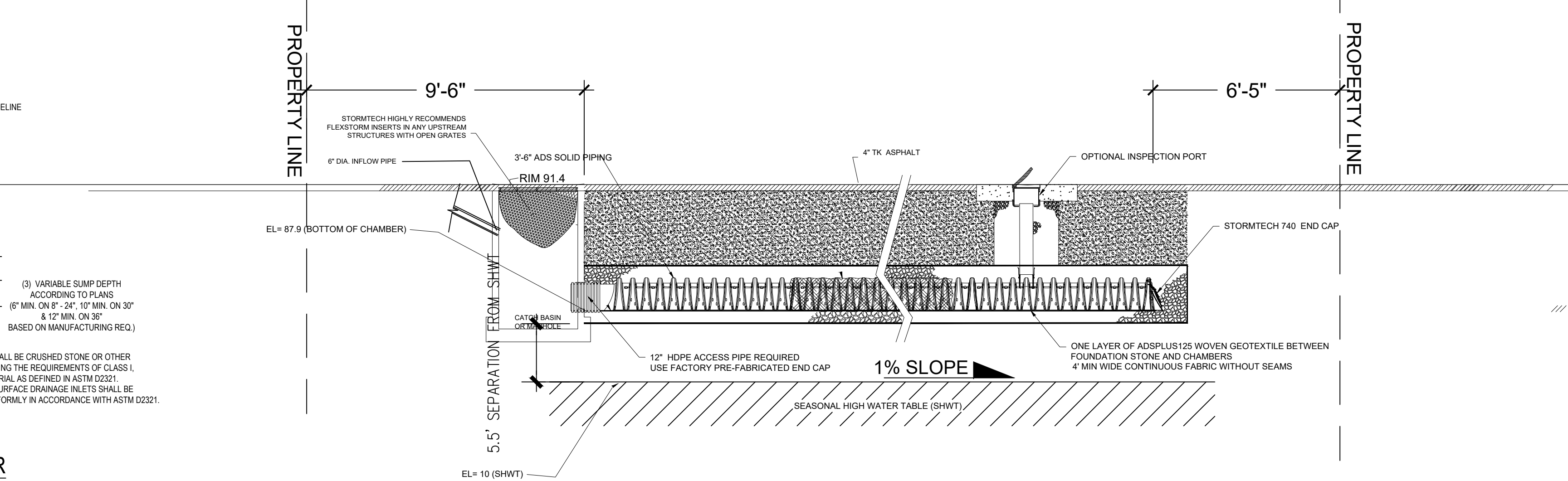

1-1 STORM COLLECTOR ROW DETAIL NOT TO SCALE

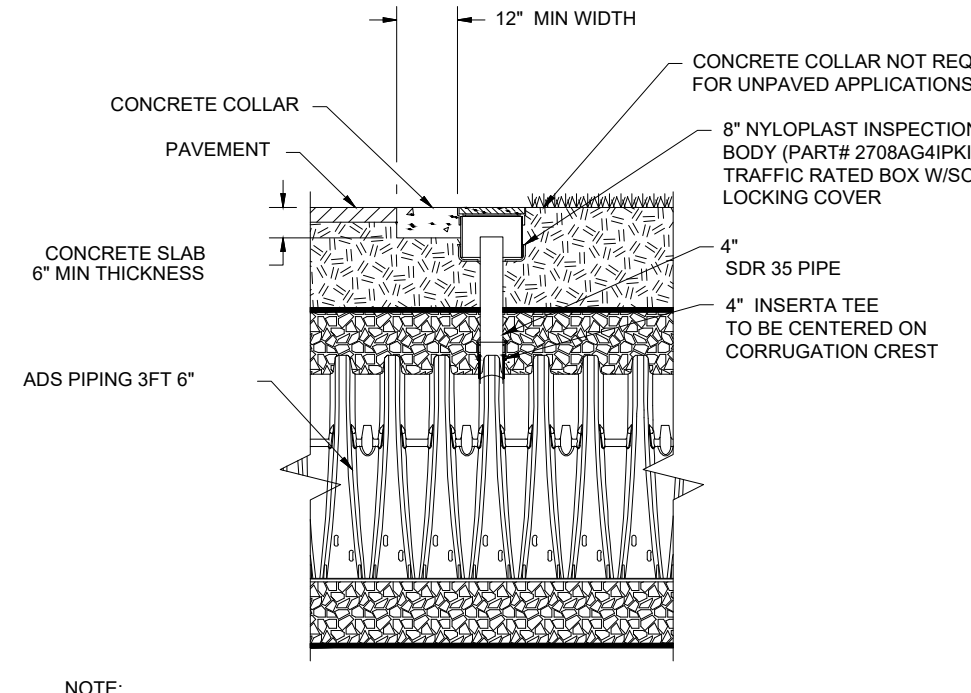

4" PVC INSPECTION PORT DETAIL (SC SERIES CHAMBER) NTS

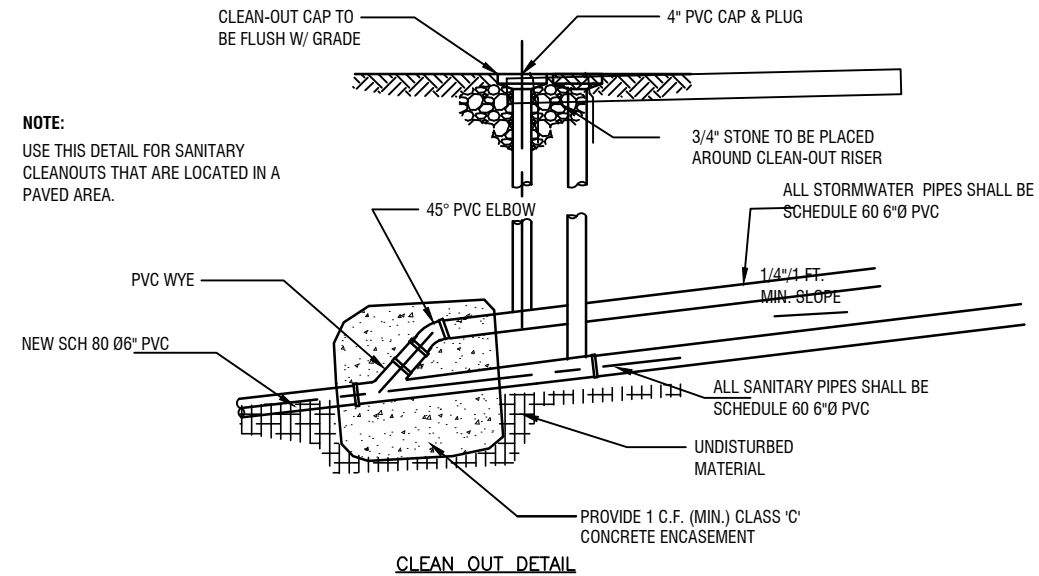

4 SANITARY CLEAN-OUT IN PAVEMENT

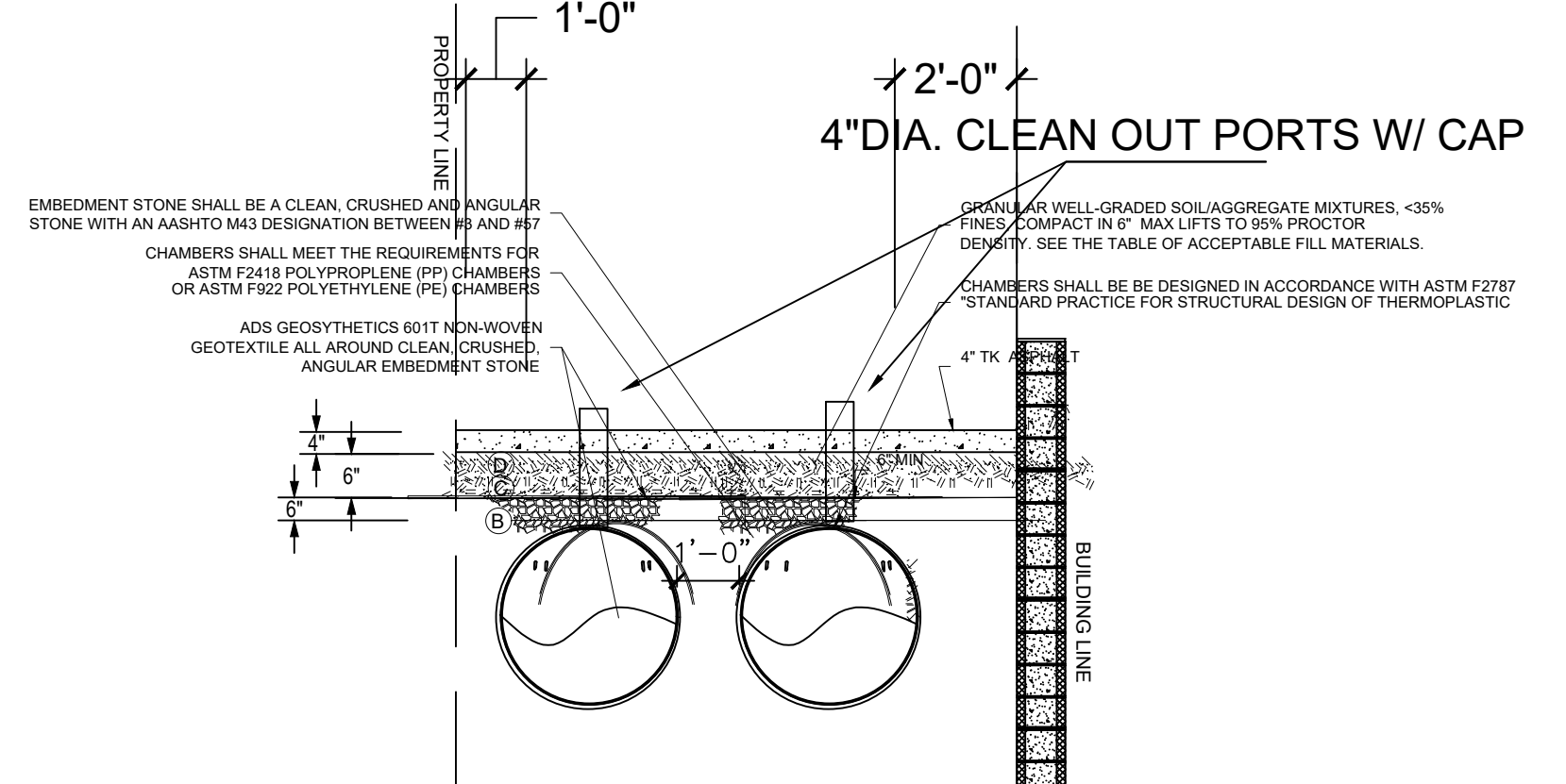

2-2 STORM SECTION DETAIL NOT TO SCALE

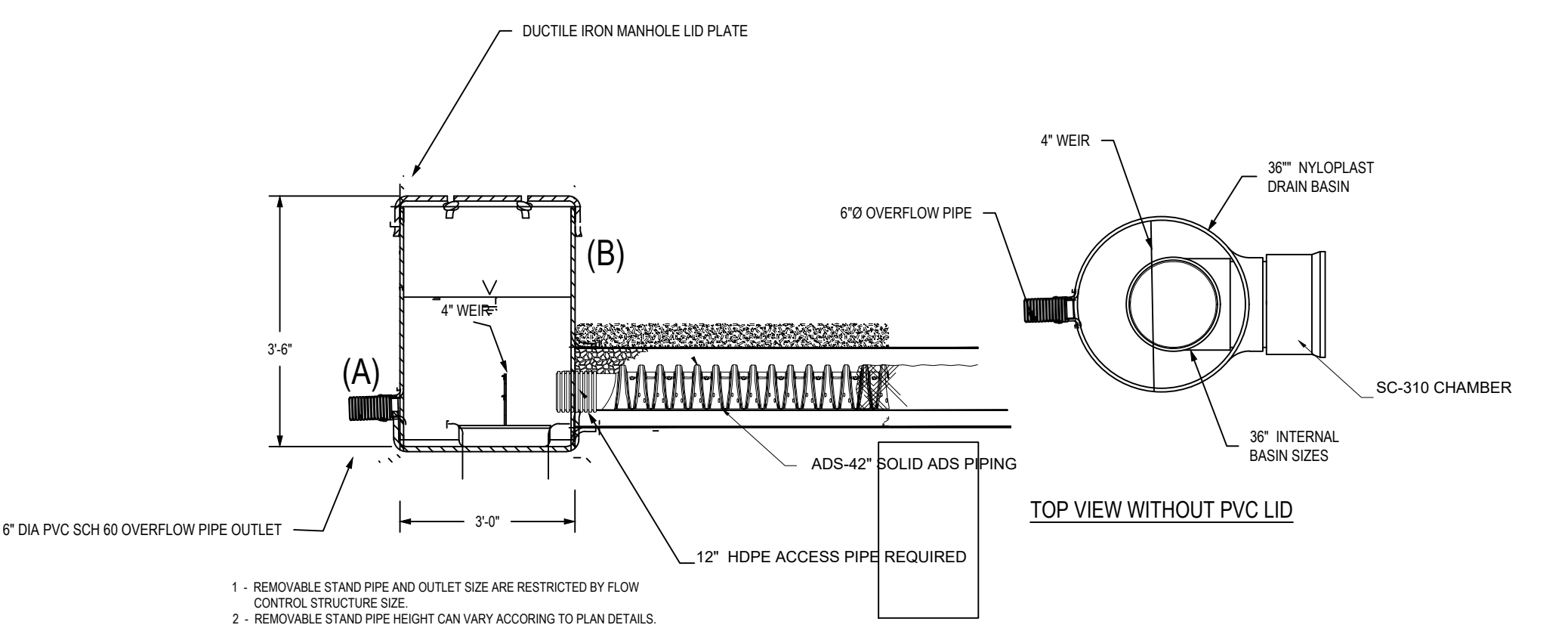

2 NYLOPLAST WATER OUTLET CONTROL STRUCTURE

- 1 - REMOVABLE STAND PIPE AND OUTLET SIZE ARE RESTRICTED BY FLOW CONTROL STRUCTURE SIZE.
- 2 - REMOVABLE STAND PIPE HEIGHT CAN VARY ACCORDING TO PLAN DETAILS.
- 3 - FLOW CONTROL STRUCTURE TO BE CUSTOM MANUFACTURED ACCORDING TO PLAN DETAILS. RISERS ARE NEEDED FOR BASINS OVER 84" DUE TO SHIPPING RESTRICTIONS.
- 4 - DRAINAGE CONNECTION STUB JOINT TIGHTNESS SHALL CONFORM TO ASTM D3212 FOR CORRUGATED HDPE (ADS N-12 HANCOR DUAL WALL).
- 5 - ADAPTERS CAN BE MOUNTED ON ANY ANGLE 0° TO 360°. TO DETERMINE MINIMUM ANGLE BETWEEN ADAPTERS SEE DRAWING NO. 7001-110-012.
- 6 - DRIFICE HOLES ARE DEPENDENT ON RISER PIPE SIZE.



OPTIMIZED ENGINEERING ASSOCIATES
400 38TH STREET, SUITE 307
UNION CITY, NJ 07087
201-430-9173
201-866-0913 (FAX)
E-mail: guy@oea-corp.com
Web: www.oea-corp.com

REVIEWS:	NO.	DATE	DESCRIPTION	APPROD

PROJECT LOCATION:
14-18 VAP REIPEN AVE
LOT 32,33&34 BLOCK 7903
JERSEY CITY, NJ

PROJECT DESCRIPTION:
NEW MIX-USED BUILDING
CIVIL PLAN & NOTES

SEAL: *[Signature]*

DR. GJ TR. GJ
CK CK DES CK
GUY LAGOMARSINO, P.E.
PROFESSIONAL ENGINEER
LICENSE NO. (NJ): 248240534

SCALE:
NTS

DATE:
APRIL 2022

C-303
SHEET 8 OF 9