



Steven M. Fulop
Mayor

CITY OF JERSEY CITY
DEPARTMENT OF INFRASTRUCTURE
Division of Transportation Planning
Municipal Services Complex
13-15 Linden Avenue East, Jersey City, NJ 07305
Department: 201-547-4727 | Division: 201-547-5069



Barkha R Patel
Director

MEMORANDUM

DATE: August 22, 2023

TO: Zoning Board

FROM: Michael Manzella, Lyndsey Scofield, Division of Transportation Planning; Jennifer Wong, Division of Traffic Engineering

SUBJECT: 64-68 Harmon Street and 413-419 Arlington Avenue

The Division of Transportation Planning and Division of Traffic Engineering reviewed the revised site plans dated 06-20-2023 and 8-7-2023 submitted by R&D Design Group and Anderson Consulting Services, respectively.

1. Driveway

- (a) The Divisions previously provided comments regarding the driveway apron and sidewalk to ensure continuity of the sidewalk across the driveway. It appears that these changes have been made to the Civil site plan (SP-4) as shown below, but has not been updated in the Architecture set.

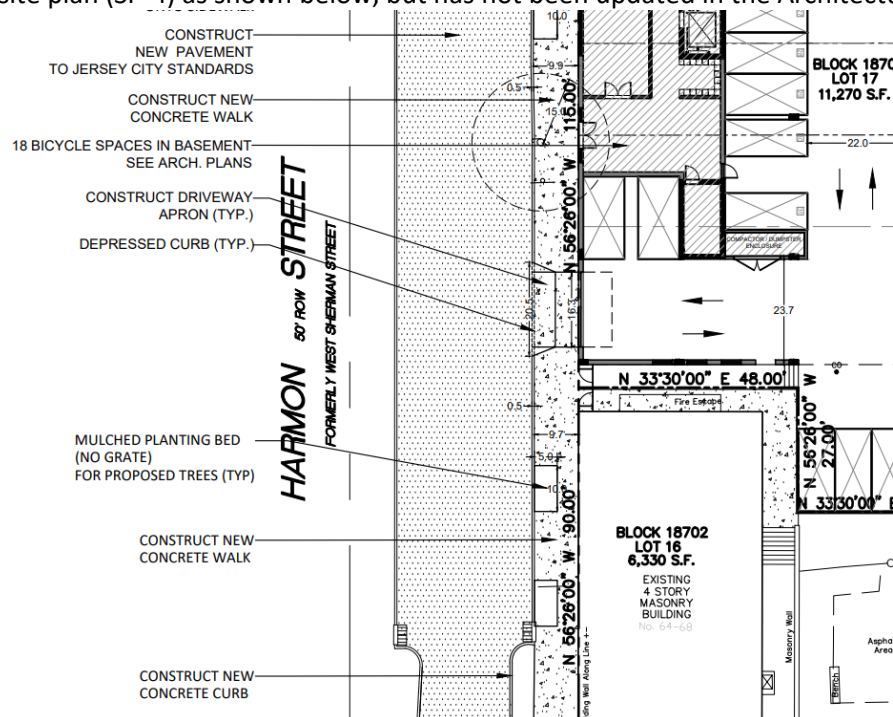

-
- *PROPOSED 1ST FLOOR PLAN**
 SCALE: 1/8" = 1'-0"
 PROJECT: 1100 W. SHERMAN ST. 1100 W. SHERMAN ST.



(a) The Divisions have not received information that indicates whether this site is compliant with New Jersey's electric vehicle charging requirements. A [model statewide municipal electric vehicle \(EV\) ordinance](#) was published by the New Jersey Department of Community Affairs on September 1, 2021, to comply with P.L. 2021, c. 171. The model statewide ordinance is mandatory for all municipalities and requires installation of a certain number or percentage of make-ready electric vehicle charging spaces and installation of electric vehicle charging as part of the preliminary site plan approval process.

(b) Please confirm that the proposed parking is compliant with the model statewide EV ordinance.