

ELEVATIONS

EXTERIOR



1 PROPOSED LEFT SIDE ENTRANCE ELEVATION
SCALE: NTS



2 PROPOSED TONNELLE AVE. ELEVATION
SCALE: NTS



CUSTOMER: THE MEDICINE WOMAN

PROJECT: EXTERIOR SIGN PACKAGE

ADDRESS: 660 TONNELE AVE.
JERSEY CITY, NJ 07307

PROJ. MGR.: RICHELLE JENSEN ☎ 714.399.3376

DESIGNER: KIM HEFFERNAN ☎ 714.399.3392

REV. NOTES: -

FILE PATH: 2022/The Medicine Woman/221113_Permit Package/

REVISION #: 01

REVISION DATE: 12.2.2022

PENDING APPROVAL
PLEASE REVIEW THIS PROJECT PROOF CAREFULLY FOR ALL DETAILS, INCLUDING COLOR, MATERIALS, AND SPELLING. SUNSET SIGNS IS NOT RESPONSIBLE FOR ANY INCORRECT DESIGN LAYOUT, CONTENT INFORMATION, OR MISPELLING AFTER APPROVAL.

INSTALL
1 of 6



ILLUMINATED PANAFLEX SIGN WITH FRAME

EXTERIOR

SQ. FT. = 20.625

PROJECT **221113**

QTY. x1

SCOPE OF WORK

MANUFACTURE (1) ILLUMINATED CABINET SIGN WITH 4" DEEP RETURNS AND PANAFLEX INSERT. INCLUDES LED ILLUMINATION, UL LISTED COMPONENTS AND POWER SUPPLY(S).



1 FRONT VIEW / MEASUREMENTS
SCALE: NTS

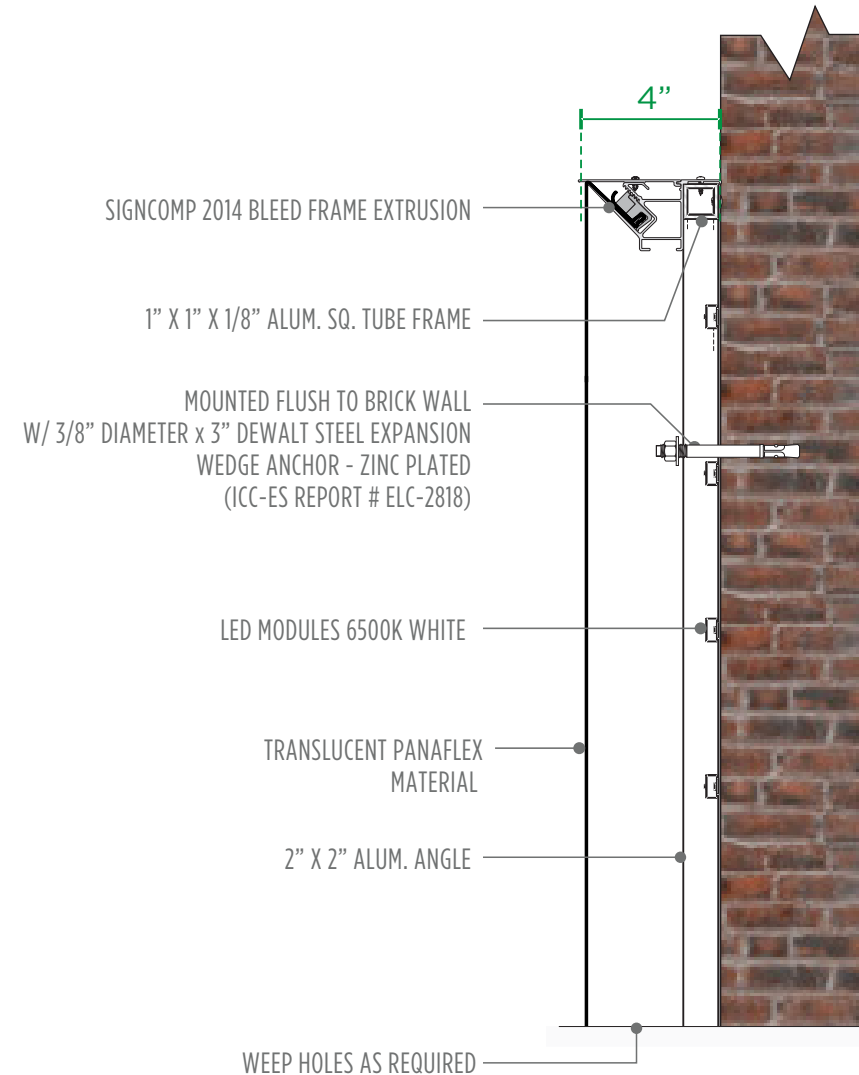

2 SIDE VIEW INSTALLATION DETAIL
SCALE: NTS

SUNSET SIGNS 
A SIGN OF EXCELLENCE SINCE 1992 LIC. #908474 C45

CUSTOMER: THE MEDICINE WOMAN

PROJECT: EXTERIOR SIGN PACKAGE

ADDRESS: 660 TONNELE AVE.
JERSEY CITY, NJ 07307

PROJ. MGR.: RICHELLE JENSEN ☎ 714.399.3376

DESIGNER: KIM HEFFERNAN ☎ 714.399.3392

REV. NOTES: -

FILE PATH: 2022/The Medicine Woman/221113_Permit Package/

REVISION #: 01

REVISION DATE: 12.2.2022

PENDING APPROVAL
PLEASE REVIEW THIS PROJECT PROOF CAREFULLY FOR ALL DETAILS, INCLUDING COLOR, MATERIALS, AND SPELLING. SUNSET SIGNS IS NOT RESPONSIBLE FOR ANY INCORRECT DESIGN LAYOUT, CONTENT INFORMATION, OR MISSPELLING AFTER APPROVAL.

INSTALL
2 of 6



ILLUMINATED REVERSE CHANNEL LETTERS

EXTERIOR

SQ. FT. = 47.67

QTY. x1

SCOPE OF WORK

MANUFACTURE (1) SET REVERSE HALO LIT CHANNEL LETTERS.
INCLUDES LED ILLUMINATION, UL LISTED COMPONENTS AND POWER SUPPLY(S).

PROJECT **221113**

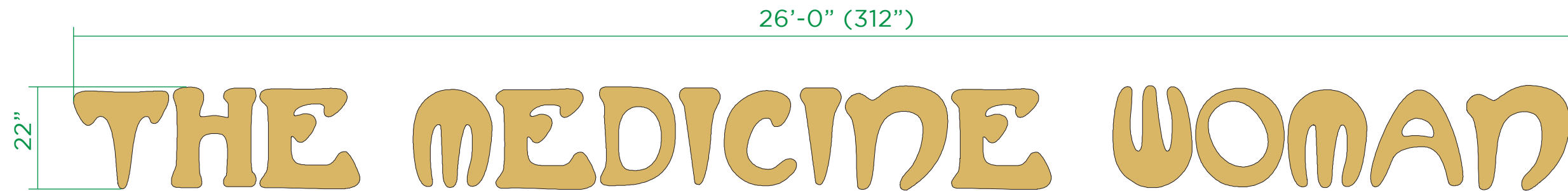

1 FRONT VIEW / MEASUREMENTS
SCALE: NTS



CUSTOMER: THE MEDICINE WOMAN

PROJECT: EXTERIOR SIGN PACKAGE

ADDRESS: 660 TONNELE AVE.
JERSEY CITY, NJ 07307

PROJ. MGR.: RICHELLE JENSEN ☎ 714.399.3376

DESIGNER: KIM HEFFERNAN ☎ 714.399.3392

REV. NOTES: -

FILE PATH: 2022/The Medicine Woman/221113_Permit Package/

REVISION #: 01

REVISION DATE: 12.2.2022

PENDING APPROVAL

PLEASE REVIEW THIS PROJECT PROOF CAREFULLY FOR ALL DETAILS, INCLUDING COLOR, MATERIALS, AND SPELLING. SUNSET SIGNS IS NOT RESPONSIBLE FOR ANY INCORRECT DESIGN LAYOUT, CONTENT INFORMATION, OR MISSPELLING AFTER APPROVAL.

INSTALL

3 of 6



ILLUMINATED REVERSE CHANNEL LETTERS

EXTERIOR

SQ. FT. = 4

QTY. x1

SCOPE OF WORK

MANUFACTURE (1) SET REVERSE HALO LIT CHANNEL LETTERS.
INCLUDES LED ILLUMINATION, UL LISTED COMPONENTS AND POWER SUPPLY(S).

PROJECT **221113**



1 FRONT VIEW / MEASUREMENTS
SCALE: NTS



CUSTOMER: THE MEDICINE WOMAN

PROJECT: EXTERIOR SIGN PACKAGE

ADDRESS: 660 TONNELE AVE.
JERSEY CITY, NJ 07307

PROJ. MGR.: RICHELLE JENSEN ☎ 714.399.3376

DESIGNER: KIM HEFFERNAN ☎ 714.399.3392

REV. NOTES: -

FILE PATH: 2022/The Medicine Woman/221113_Permit Package/

REVISION #: 01

REVISION DATE: 12.2.2022

PENDING APPROVAL
PLEASE REVIEW THIS PROJECT PROOF CAREFULLY FOR ALL DETAILS, INCLUDING COLOR, MATERIALS, AND SPELLING. SUNSET SIGNS IS NOT RESPONSIBLE FOR ANY INCORRECT DESIGN LAYOUT, CONTENT INFORMATION, OR MISSPELLING AFTER APPROVAL.

INSTALL
4 of 6



ILLUMINATED REVERSE CHANNEL LETTERS

EXTERIOR

PROJECT **221113**

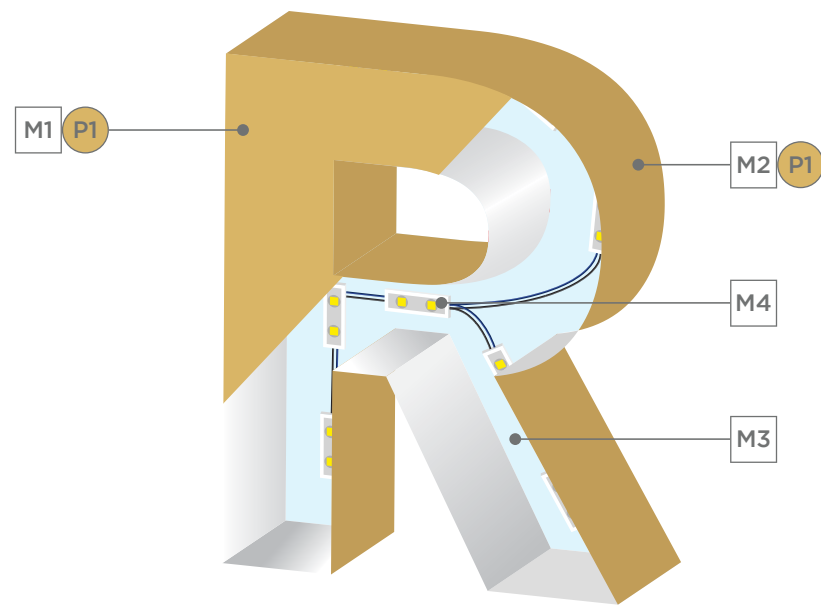

1 FABRICATION DETAIL
SCALE: NTS

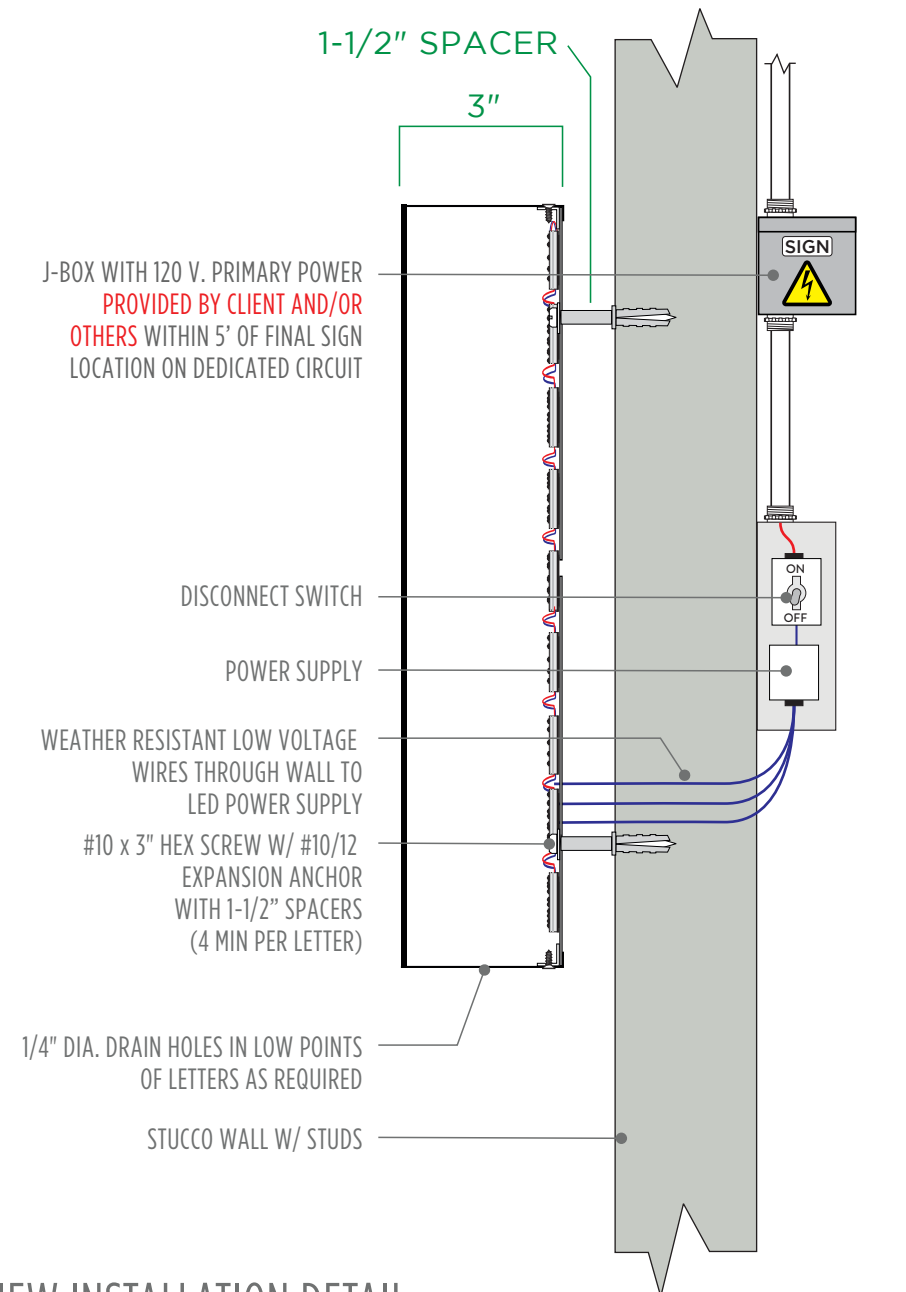

2 SIDE VIEW INSTALLATION DETAIL
SCALE: NTS

MATERIALS		COLORS
M1	.090" THK. ALUMINUM FACES	P1 BENJAMIN MOORE STUART GOLD, HC-10
M2	.063" THK. ALUMINUM RETURNS	
M3	.177" THK. CLEAR LEXAN BACKS	
M4	WHITE LEDS 6500K	



SUNSET SIGNS 
A SIGN OF EXCELLENCE SINCE 1992 LIC. #908474 C45

CUSTOMER: THE MEDICINE WOMAN	PROJ. MGR.: RICHELLE JENSEN ☎ 714.399.3376	REVISION #: 01
PROJECT: EXTERIOR SIGN PACKAGE	DESIGNER: KIM HEFFERNAN ☎ 714.399.3392	REVISION DATE: 12.2.2022
ADDRESS: 660 TONNELE AVE. JERSEY CITY, NJ 07307	REV. NOTES: -	
FILE PATH: 2022/The Medicine Woman/221113_Permit Package/		

PENDING APPROVAL
PLEASE REVIEW THIS PROJECT PROOF CAREFULLY FOR ALL DETAILS, INCLUDING COLOR, MATERIALS, AND SPELLING. SUNSET SIGNS IS NOT RESPONSIBLE FOR ANY INCORRECT DESIGN LAYOUT, CONTENT INFORMATION, OR MISSPELLING AFTER APPROVAL.

INSTALL
5 of 6

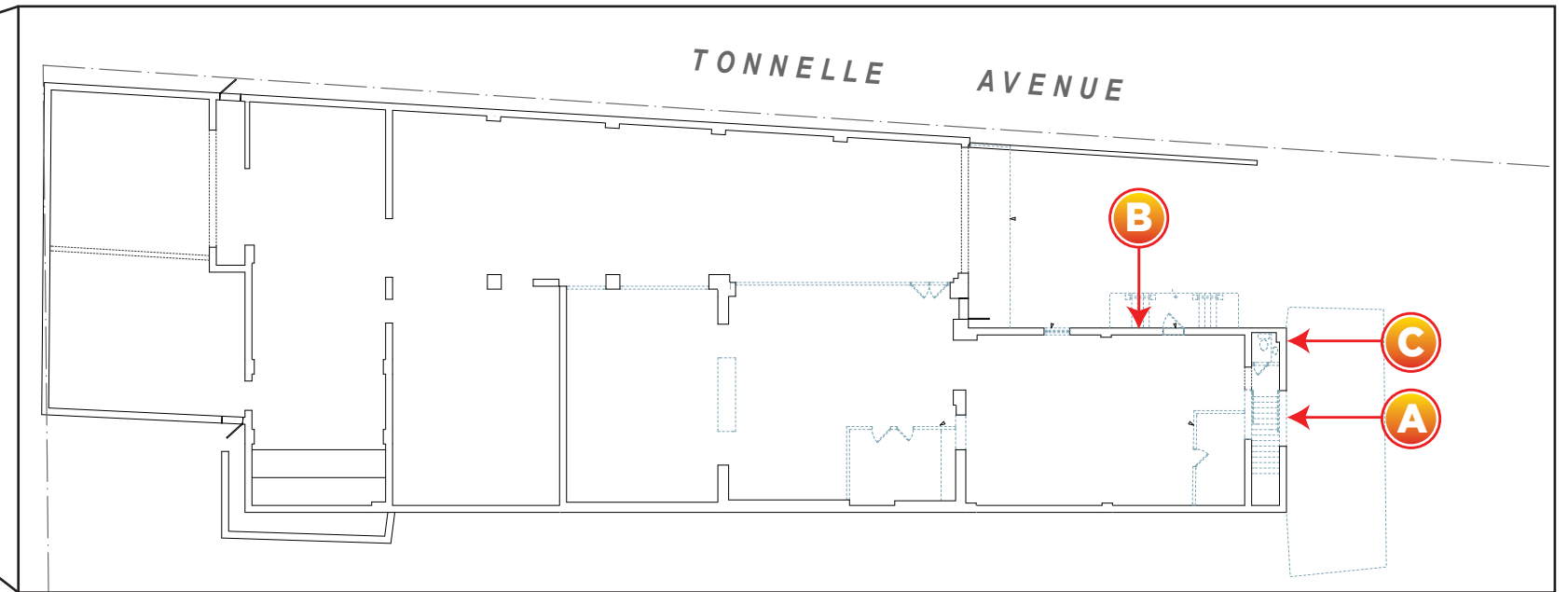

 SITE MAP
SCALE: NTS

SUNSET SIGNS 
A SIGN OF EXCELLENCE SINCE 1992 LIC. #908474 C45

CUSTOMER: THE MEDICINE WOMAN

PROJECT: EXTERIOR SIGN PACKAGE

ADDRESS: 660 TONNELE AVE.
JERSEY CITY, NJ 07307

PROJ. MGR.: RICHELLE JENSEN ☎ 714.399.3376

DESIGNER: KIM HEFFERNAN ☎ 714.399.3392

REV. NOTES: -

FILE PATH: 2022/The Medicine Woman/221113_Permit Package/

REVISION #: 01

REVISION DATE: 12.2.2022

PENDING APPROVAL
PLEASE REVIEW THIS PROJECT PROOF CAREFULLY FOR ALL DETAILS, INCLUDING COLOR, MATERIALS, AND SPELLING. SUNSET SIGNS IS NOT RESPONSIBLE FOR ANY INCORRECT DESIGN LAYOUT, CONTENT INFORMATION, OR MISPELLING AFTER APPROVAL.

INSTALL
6 of 6