

STORMWATER TANK SECTION

N.T.S.

SEWER CONNECTION
INV.=103.7 +/-

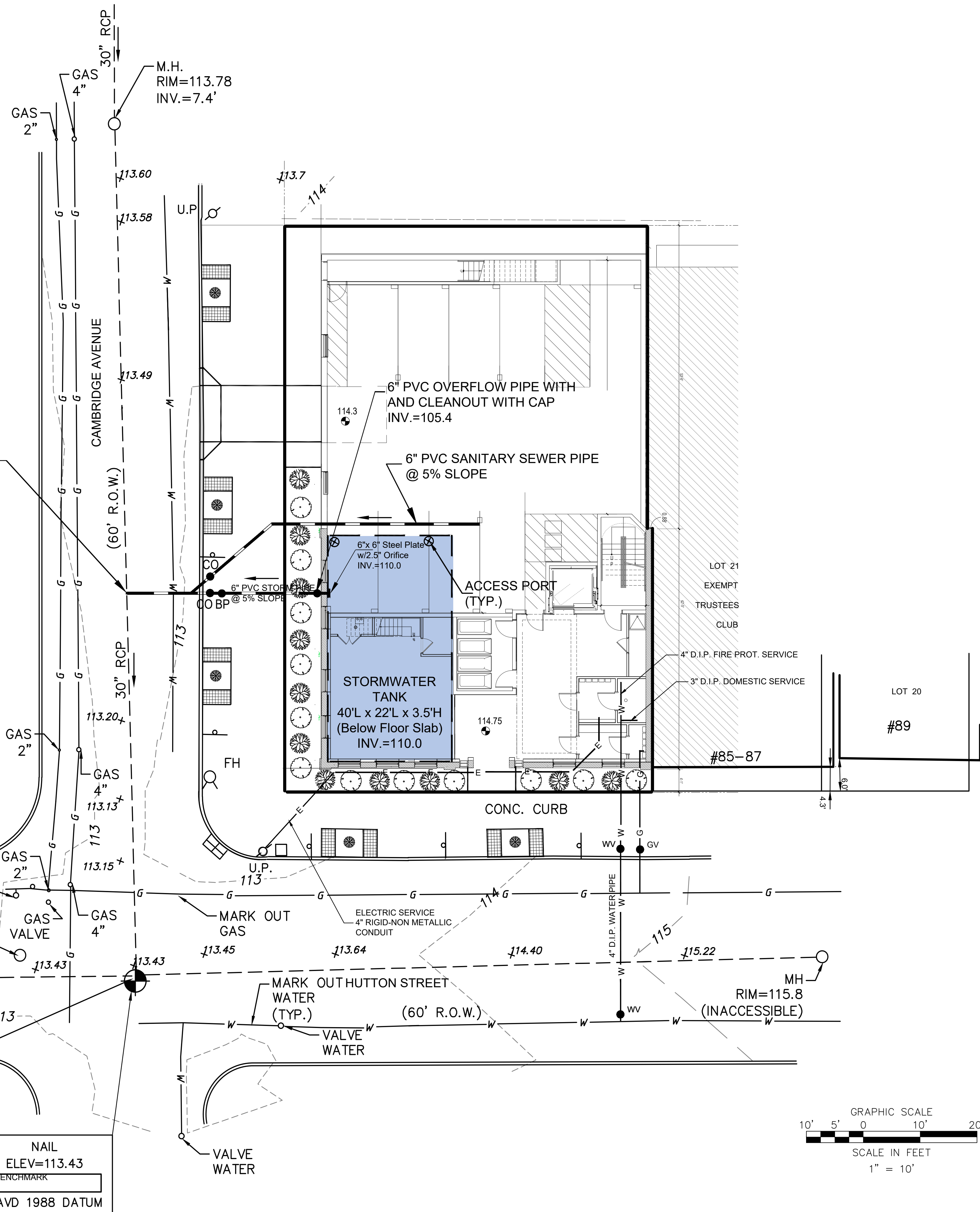

NAIL
ELEV=113.43
BENCHMARK
NAVD 1988 DATUM

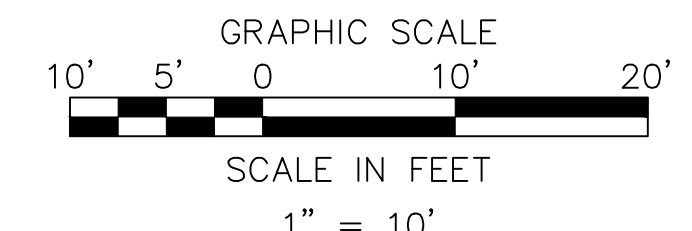

NOTES:
THE EXISTING CONDITIONS DEPICTED ON THIS DRAWING ARE TAKEN FROM A TOPOGRAPHIC AND BOUNDARY SURVEY ISSUED BY V4 LAND SURVEYING PLLC WITH OFFICE IN HOBOKEN, NJ 07030 AND DATED 3/19/2020.

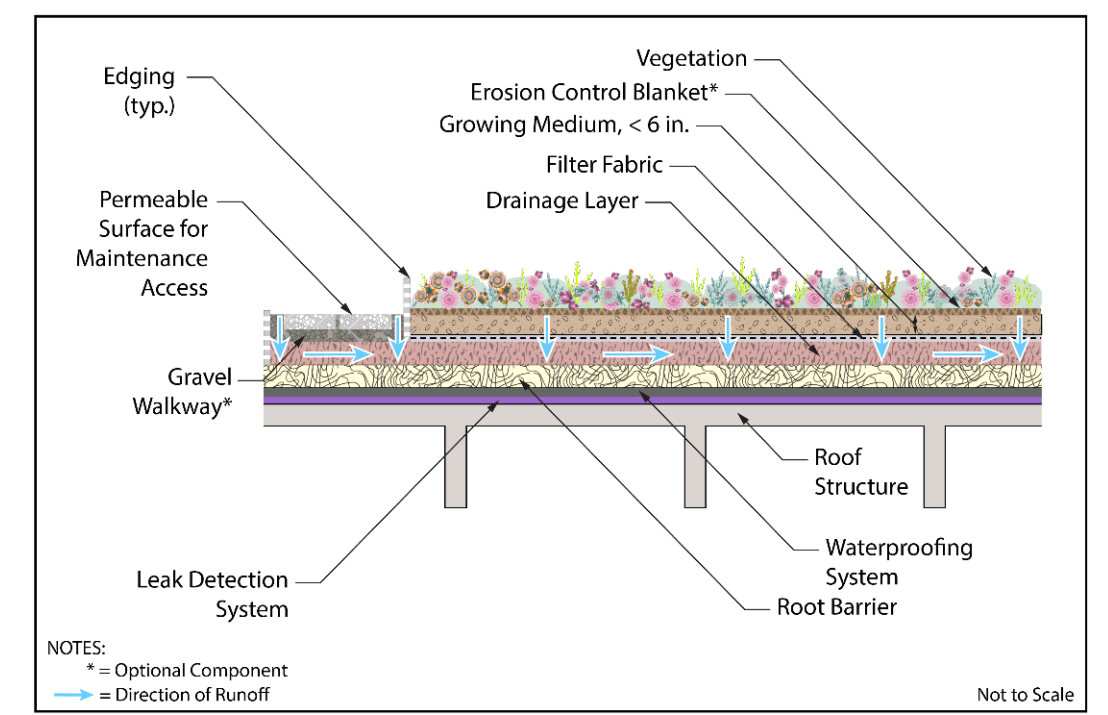

NOTE: Green roof vegetation to be selected from the approved Species List published by the Greenbelt Native Plant Center. See NJDEP-BMP Chapter 9:14 Green Roofs.

07/25/2023	Revised background and stormwater tank	B.A.C.	E.R.
Date	Revision	Drawn By:	Checked By:
81-83 HUTTON STREET BLOCK 4404 LOT 2 City of Jersey City Hudson County New Jersey			
DRAINAGE & UTILITY PLAN			
Edwin A. Reimon 11 Park Avenue Rutherford, NJ 07070 201-438-001 reimon5@msn.com		Job #: 2022 - 6000 Scale: AS SHOWN Date: 8/25/2022	
Edwin A. Reimon, P.E. NJ PROFESSIONAL ENGINEER NO. 24GE03869400		Drawn By: A.R. Checked By: E.A.R.	Sheet #: C-1