



CITY OF JERSEY CITY

Office of the City Assessor
City Hall Annex
364 M.L. King Drive, 3rd Floor
Jersey City, New Jersey 07305
Telephone: (201) 547-5131

EDUARDO TOLOZA, CITY ASSESSOR

February 15, 2023

PROPERTY LOCATION OF APPLICATION: 850 West Side Avenue

BLOCK(S): 13204 LOT(S): 69

NAME OF APPLICANT: Castano Quigley Cherami, LLC
236A Newark Avenue
Jersey City, NJ 07302

APPLICANT'S TELEPHONE #: (201) 413-9000

Pursuant to your request, attached herewith is a list of properties located within the 200-foot radius of the above-captioned property. This list contains the owner's name, mailing address, block, lot and property location as reflected on the most recent Assessor's Tax List.

C E R T I F I E D

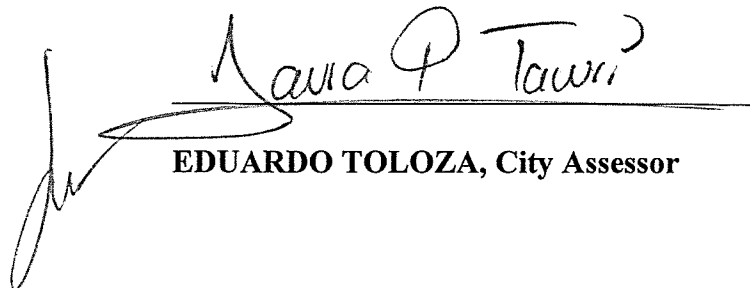

EDUARDO TOLOZA, City Assessor

In addition to herein list, the following must also be notified:

P.S.E.& G.	80	PARK PLAZA, NEWARK, NEW JERSEY 07102
COMCAST CABLEVISION	2121	KENNEDY BLVD., JERSEY CITY, NJ 07305
UNITED WATER COMPANY	200	HOOK ROAD, HARRINGTON PARK, NJ 07640
JERSEY CITY M.U.A.	555	ROUTE 440, JERSEY CITY, NEW JERSEY 07305
VERIZON TELEPHONE	540	BROAD STREET, NEWARK, NEW JERSEY 07102

Buffer Report - Map

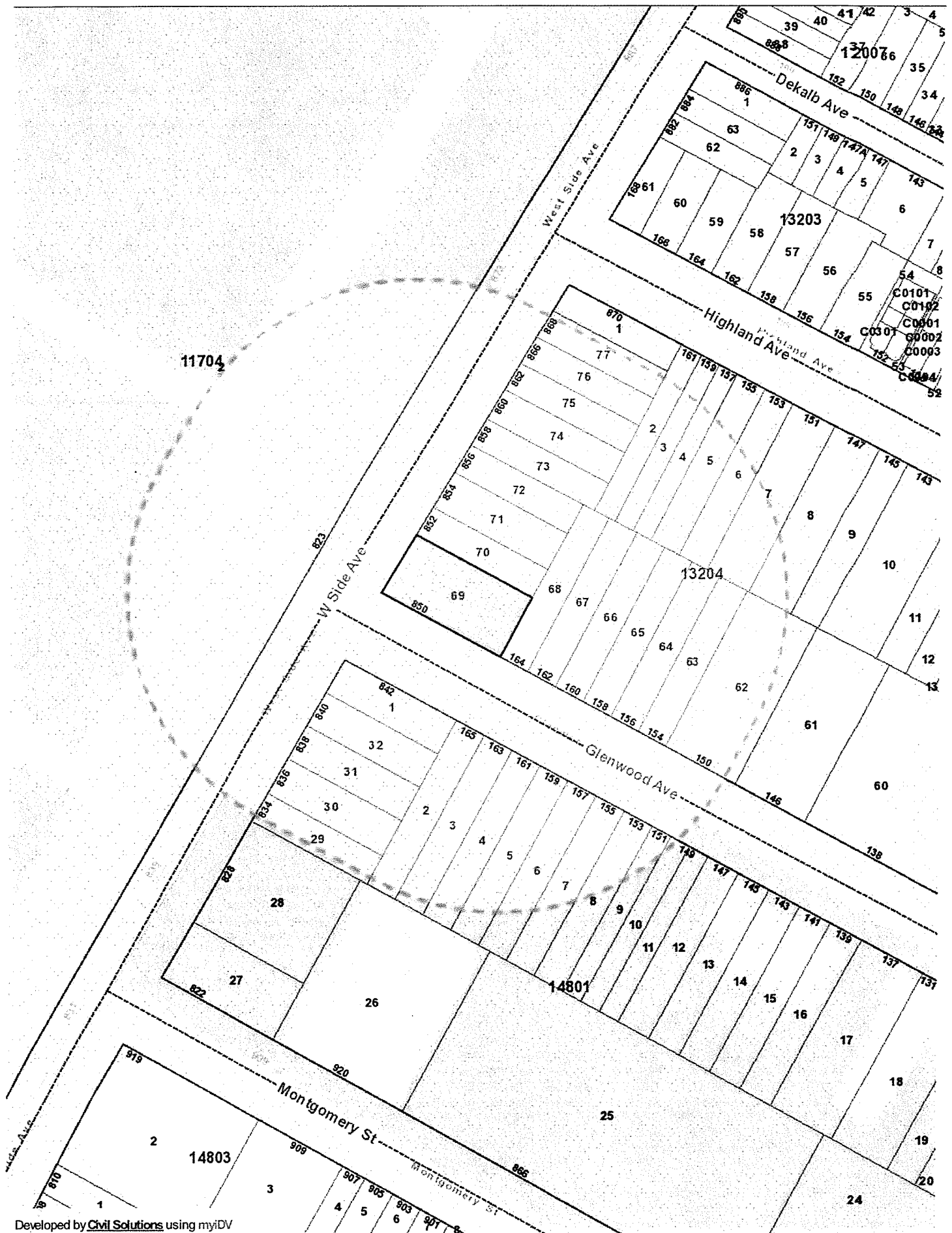
Jersey City





CITY OF JERSEY CITY

Office of the City Assessor

Subject Property: Block 13204 - Lot 69

Block & Lot listing of properties within 200 ft. radius of subject property.

Property Location: 850 West Side Avenue

Date: February 15, 2023

BLOCK	LOT	QUAL	PROPERTY LOCATION	OWNERS NAME	MAILING ADDRESS	CITY / STATE	ZIP CODE
11704	2		823 WEST SIDE AVE	HOLY NAME CMTRY. % R.C. ARCHDIOCESE	171 CLIFTON AVE.	NEWARK, NJ	07104
13204	2		161 HIGHLAND AVE.	GARRETSON, SHAKIMIAH	161 HIGHLAND AVE	JERSEY CITY, NJ	07306
13204	3		159 HIGHLAND AVE.	SEVERSON, ERIC & ADAMS, CASSANDRA J	159 HIGHLAND AVE.	JERSEY CITY, NJ	07306
13204	4		157 HIGHLAND AVE.	LAKE, BRANDON & HANNON, ALYSA	157 HIGHLAND AVE.	JERSEY CITY, NJ	07306
13204	5		155 HIGHLAND AVE.	GAMBOA, CARLOS JR. & ZENDA	155 HIGHLAND AV.	JERSEY CITY, N.J.	07306
13204	6		153 HIGHLAND AVE.	TIONGSON, JAY & STEIN, SHERRY B.	6 ROWAN CT.	EAST BRUNSWICK, NJ	08816
13204	7		151 HIGHLAND AVE.	ANTONIETTA D'ANGELO MANGMT TRUST	151 HIGHLAND AVE.	JERSEY CITY, NJ	07306
13204	8		147 HIGHLAND AVE.	TUCCIARONE, L & BIANCAMANO, J	151 HIGHLAND AVE., #1	JERSEY CITY, NJ	07306
13204	62		150 GLENWOOD AVE.	ST. PETER'S COLLEGE % COLL. SERVICES	2641 KENNEDY BLVD.	JERSEY CITY, NJ	07306
13204	63		154 GLENWOOD AVE.	SEELALL, NALANIE	97 STUYVESANT AVE.	JERSEY CITY, N.J.	07306
13204	64		156 GLENWOOD AVE.	SPEES, RAYMOND	156 GLENWOOD AVE.	JERSEY CITY, NJ	07306
13204	65		158 GLENWOOD AVE.	SAROOP, HARRICHAND & OMAWATI	158 GLENWOOD AVE.	JERSEY CITY, NJ	07306
13204	66		160 GLENWOOD AVE.	OLAVARRIA, JORGE	160 GLENWOOD AVE.	JERSEY CITY, NJ	07306
13204	67		162 GLENWOOD AVE.	MEJIAS, MARILYN	162 GLENWOOD AVE.	JERSEY CITY, NJ	07306
13204	68		164 GLENWOOD AVE.	JOSEF, JESUS G. & PURITA M.	164 GLENWOOD AVE.	JERSEY CITY, N.J.	07306
13204	70		852 WEST SIDE AVE.	PATEL, ASHISHKUMAR & BHARTIBEN	852 WEST SIDE AVE.	JERSEY CITY, NJ	07306

BLOCK	LOT	QUAL	PROPERTY LOCATION	OWNERS NAME	MAILING ADDRESS	CITY / STATE	ZIP CODE
13204	71		854 WEST SIDE AVE.	ALTOBAR, MARIBEL B.	854 WEST WIDE AVE.	JERSEY CITY, NJ	07306
13204	72		856 WEST SIDE AVE.	EXPOSITO, JOSE R. & REINA E.	856 WEST SIDE AVE.	JERSEY CITY, N.J.	07306
13204	73		858 WEST SIDE AVE.	858 WEST SIDE GROUP LLC	858 WEST SIDE AVE.	JERSEY CITY, N.J.	07306
13204	74		860 WEST SIDE AVE.	BRUSCH, DAVID	860 WEST SIDE AVE	JERSEY CITY, N. J.	07306
13204	75		862 WEST SIDE AVE.	GHOBBIAL, MAGDY F & MARIAM	862 WEST SIDE AVE.	JERSEY CITY, N.J.	07306
13204	76		866 WEST SIDE AVE.	CUESTA, DANIEL & CATHERINE	868 WEST SIDE AVE.	JERSEY CITY, N.J.	07306
13204	77		868 WEST SIDE AVE.	CUESTA, DANIEL & CATHERINE	868 WEST SIDE AVE.	JERSEY CITY, N.J.	07306
14801	1		842 WEST SIDE AVE.	ST. PETER'S COLLEGE % COLL.SERVICES	2641 KENNEDY BLVD.	JERSEY CITY, NJ	07306
14801	2		165 GLENWOOD AVE.	ST PETER'S UNIVERSITY	2641 KENNEDY BLVD.	JERSEY CITY, NJ	07306
14801	3		163 GLENWOOD AVE.	MC PHERSON, LEONARD & WILHELMINA	163 GLENWOOD AVE.	JERSEY CITY, N.J.	07306
14801	4		161 GLENWOOD AVE.	MC PHERSON, LEONARD & WILHELMINA	163 GLENWOOD AVE	JERSEY CITY, N.J.	07306
14801	5		159 GLENWOOD AVE.	RONAN, DERMOT	159 GLENWOOD AVE.	JERSEY CITY, NJ	07306
14801	6		157 GLENWOOD AVE.	133 PROSPECT JC, LLC	1 UNIVERSITY PLAZA #508	HACKENSACK, NJ	07601
14801	7		155 GLENWOOD AVE.	HOYOS, EDGAR	155 GLENWOOD AVE.	JERSEY CITY, N.J.	07306
14801	8		153 GLENWOOD AVE.	ST. PETER'S UNIVERSITY	2641 KENNEDY BLVD	JERSEY CITY, NJ	07306
14801	9		151 GLENWOOD AVE.	BARSOUM, WADID	85 JORDAN AVE	JERSEY CITY, NJ	07306
14801	10		149.5 GLENWOOD AVE.	SAYERS, CARSON	48 SHS	AUGUSTA, ME.	04333
14801	29		834 WEST SIDE AVE.	ST. PETER'S COLLEGE	2641 KENNEDY BLVD.	JERSEY CITY, N.J.	07306
14801	30		836 WEST SIDE AVE.	ST. PETER'S COLLEGE % COLL.SERVICES	2641 KENNEDY BLVD.	JERSEY CITY, NJ	07306
14801	31		838 WEST SIDE AVE.	ST. PETER'S COLLEGE % COLL.SERVICES	2641 KENNEDY BLVD.	JERSEY CITY, NJ	07306
14801	32		840 WEST SIDE AVE.	SAINT PETERS UNIVERSITY	2641 KENNEDY BLVD	JERSEY CITY, NJ	07306